

ମୌଜା ଅଲରପୁର ସିଟ୍ ନଂ ୧

ଆନା - ବାଲିଆନ୍ତା ନଂ ୩୫
 ଚତୁର୍ଥାଂଶ - ଭୁବନେଶ୍ୱର ନଂ ୩୨୯
ALARPUR SHEET No.1
 Thana - Baliañta No.35

ଜିଲ୍ଲାପୁର

ସ୍କେଲ ୧୨ଇଞ୍ଚ : ୧ ମାଇଲ Scale 16 inches to 1 mile
 ସନ ୧୯୭୦-୧୧ Year 1960-61

ମୌଜା-ସତ୍ୟଭାମାପୁର

ଆନା - ବାଲିଆନ୍ତା ନଂ ୩୫
 ଚତୁର୍ଥାଂଶ - ଭୁବନେଶ୍ୱର ନଂ ୩୨୯
SATYABHAMAPUR
 Thana - Baliañta No 34

ଜିଲ୍ଲାପୁର

ସ୍କେଲ ୧୨ଇଞ୍ଚ : ୧ ମାଇଲ Scale 16 inches to 1 mile
 ସନ ୧୯୭୦-୧୧ Year 1970-80

ଆକାର ଓ ରଙ୍ଗ

ପ୍ରାଥମିକ, ଦେଶୀୟାଣା	Δ ○
ଆସିନିଆର ପଥର, ଖୁଣ୍ଟା	□ ○
ପ୍ରାଥମିକ, ପ୍ରାଥମିକ	□ ○
ପଥର, ଆସିନିଆର	□ ○
ଗୋଦାଳ, କୃତ୍ରିମ ବାସ୍ତୁ	□ ○
ଚକ୍ରାଳ, ବାହାରିଆଣା	□ ○

ମୌଜା ଅଲରପୁର ସିଟ୍ ନଂ ୨

ଆନା - ବାଲିଆନ୍ତା ନଂ ୩୫
 ଚତୁର୍ଥାଂଶ - ଭୁବନେଶ୍ୱର ନଂ ୩୨୯
ALARPUR SHEET No.2
 Thana - Baliañta No.35

ଜିଲ୍ଲାପୁର

ସ୍କେଲ ୧୨ଇଞ୍ଚ : ୧ ମାଇଲ Scale 16 inches to 1 mile
 ସନ ୧୯୭୦-୧୧ Year 1960-61

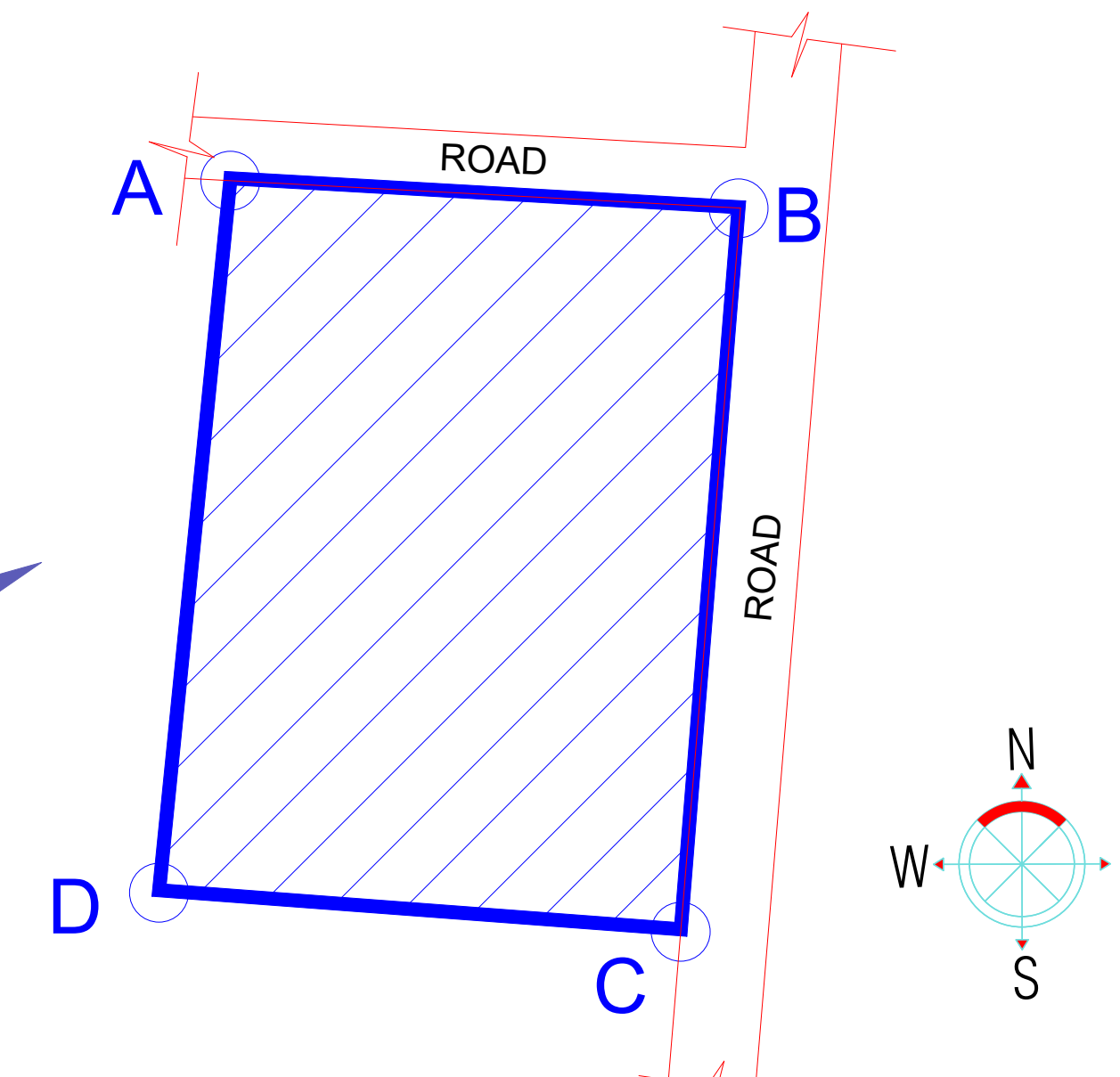
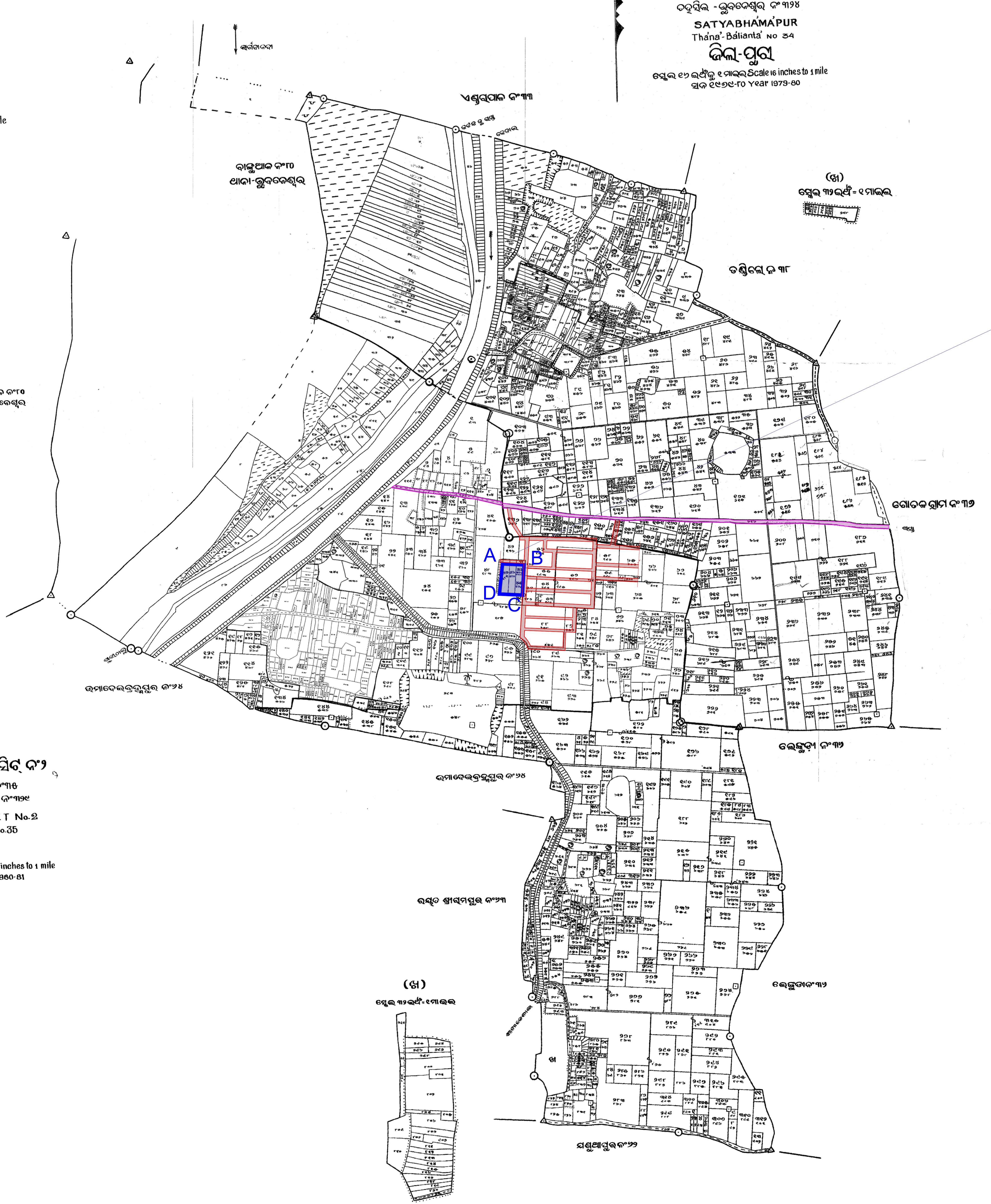

SL NO	PLOT BEND POINT	LONGITUDE	LATITUDE
1	A	20°14' 39" N	85°53'17" E
2	B	20°14' 39" N	85°53'19" E
3	C	20°14' 37" N	85°53'19" E
4	D	20°14' 37" N	85°53'17" E

NOTE

PLOT IN POSSESSION	
EXISTING REVENUE ROAD	
EXISTING GIFTED ROAD	

NOTION
 ARCHITECTS, INTERIOR AND LANDSCAPE DESIGNER
 PLOT NO. 865, HEAR NILAKANTHESWAR TEMPLE, BARAMUNDA VILLAGE, BHUBANESWAR-751003
 CONTACT NO. 9238103716, email: design@the notion.in

PROPOSED 5+5 STORED, RESIDENTIAL APARTMENT (MIG CATAGORY) AT GATIKRUSHNA GREEN FOR
 Mr. Bishnu Prasad Panda (Director),
 PANDA INFRATECH LIMITED

OWNER PLOT NO. -180, 181, 179, 178, KHATA NO. - 333711,333685,233,299,MOUZA-ALARPUR, THANA-BALIANTA, DIST-KHURDA

GEO-COORDINATES LAYOUT PLAN	SIGNATURE OF ARCHITECT Anshu Mohanty CA/2006/17468	SIGNATURE OF APPLICANT Mr. Bishnu Prasad Panda Director PANDA INFRATECH LIMITED
--------------------------------	--	--