

SL. NO.	LATITUDE	LONGITUDE
1	20°22'27.7" N	85°53'32.3" E
2	20°22'28.2" N	85°53'32.3" E
3	20°22'28.8" N	85°53'32.0" E
4	20°22'29.5" N	85°53'31.4" E
5	20°22'30.0" N	85°53'31.5" E
6	20°22'30.3" N	85°53'31.6" E
7	20°22'30.9" N	85°53'32.1" E
8	20°22'31.1" N	85°53'32.4" E
9	20°22'31.9" N	85°53'33.6" E
10	20°22'31.5" N	85°53'33.8" E
11	20°22'30.2" N	85°53'34.2" E
12	20°22'30.0" N	85°53'33.9" E
13	20°22'28.8" N	85°53'34.5" E
14	20°22'27.7" N	85°53'33.9" E
15	20°22'27.8" N	85°53'32.6" E
16	20°22'27.5" N	85°53'32.6" E

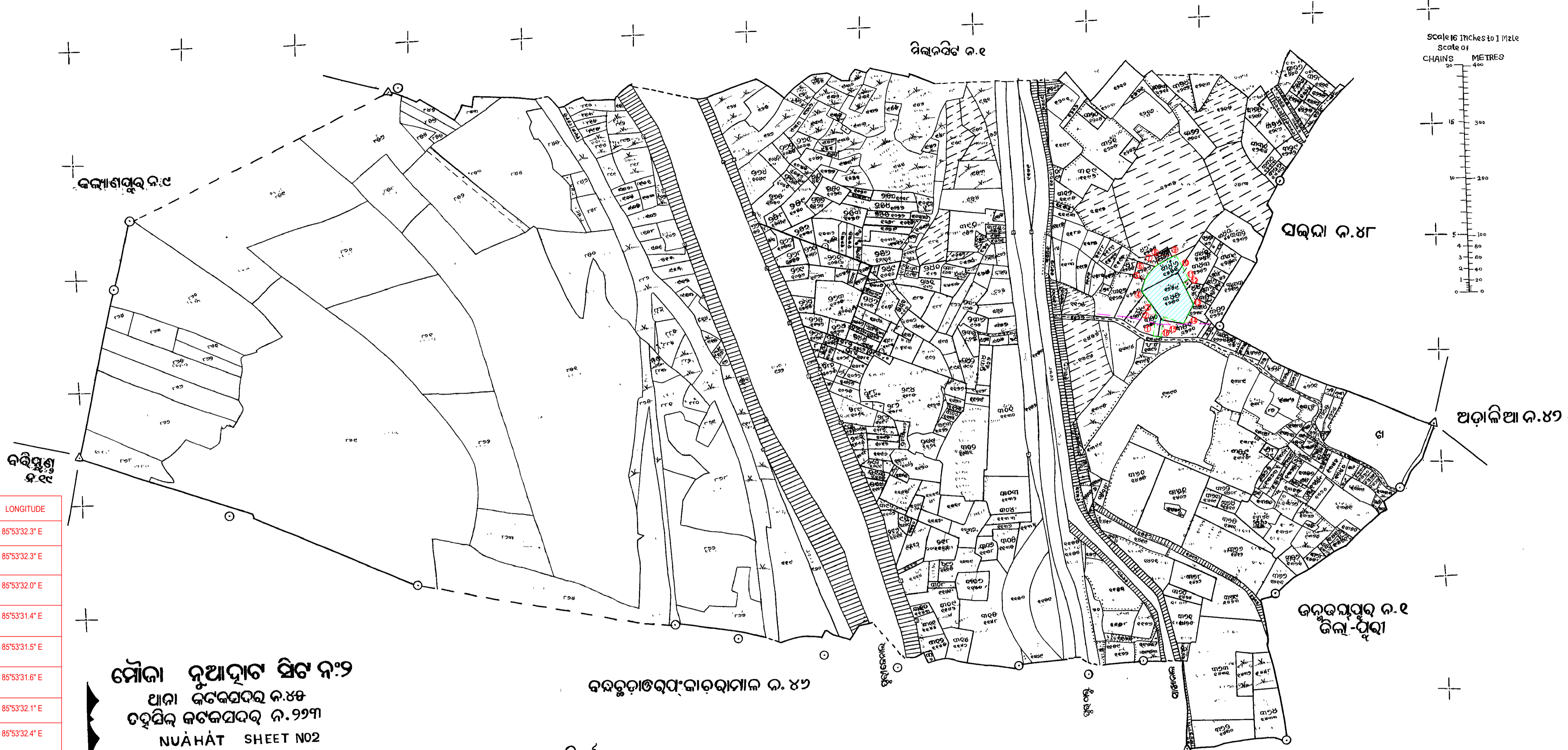

ମୌଜା ନୁଆହାଟା ସିଟ ନଂ ୨
 ଥାନା କଟକସହର ନ.୪୫
 ଚତୁର୍ଥୀକ କଟକସହର ନ.୨୨୩
NUAHAT SHEET NO2
 Thana Cuttacksadar No 45
ଜିଲ୍ଲା କଟକ
 ସ୍କେଲ ୧ଃ୧୦୦୦ = ୧ ମାଇଲ
 Year: 1983-84

For GM Infratech Ltd.
Raj Kumar
 Authorised Signatory

ନିର୍ଦ୍ଦେଶ

୧	କର୍ତ୍ତୃତ୍ୱ
୨	କର
୩	କାର୍ତ୍ତବ୍ୟାବଳୀ
୪	ପାଟି
୫	ଗ୍ରାମୀଣଜଳ
୬	କୋବର
୭	ଶାଖାବାସୀ
୮	ଝିଲିମାଳୀ
୯	କୋବିନାଳୀ
୧୦	କୂଳନାଳ

NOTES
 **PLOT IN POSSESSION**

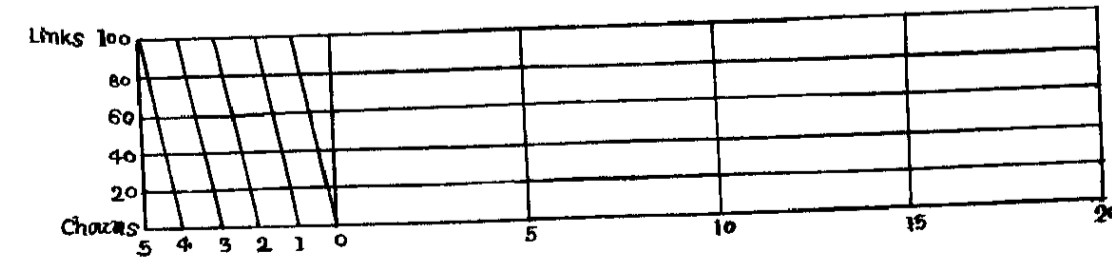

ଦୁଇ ନ. ସାମାନ୍ୟ କାର୍ତ୍ତବ୍ୟାବଳୀ

୧	୨	୩	୪	୫	୬	୭	୮	୯	୧୦
୧୦୦	୨୦୦	୩୦୦	୪୦୦	୫୦୦	୬୦୦	୭୦୦	୮୦୦	୯୦୦	୧୦୦୦

Certified that this map which has been finally prepared under sub section (1) of section 22 of the Orissa Consolidation of Holdings and prevention of Fragmentation of Land Act, 1972, has been finally published in accordance with the provision contained in sub-section (2) of the said section read with rule 26 of the Orissa Consolidation of Holdings and prevention of Fragmentation of Land Rules 1973 on 19.7.85

[Signature]
 Assistant Consolidation Officer
 Cuttack-Cuttacksadar

PROPOSED RESIDENTIAL APARTMENT BUILDING OF GM INFRA TECH LTD, REP BY DIRECTOR MR. RAJ KUMAR MISHRA, OVER PLOT NO- 1250/2114, 1247/1984, 1259/1985, 1251/1986, 1260/2326, KHATA NO-498/511, 498/320, 498/321, 498/321, 498/732 MOUZA- NUAHATA, TAHSIL/DIST- CUTTACK