

**SPACE FOR STAMP**

Technically sanctioned for.....  
 Local Sub-Divisional Layout Plan for Residential Purpose only as per the provision of Panchayat Raj & Drinking Water Department Notification No. 10868, dtd.07.8.2018, subject to the conditions contained in this Office Letter No. 19/CTPU, DA 23/03/2023  
 Assistant Engineer  
 Town Planning Unit  
 Cuttack

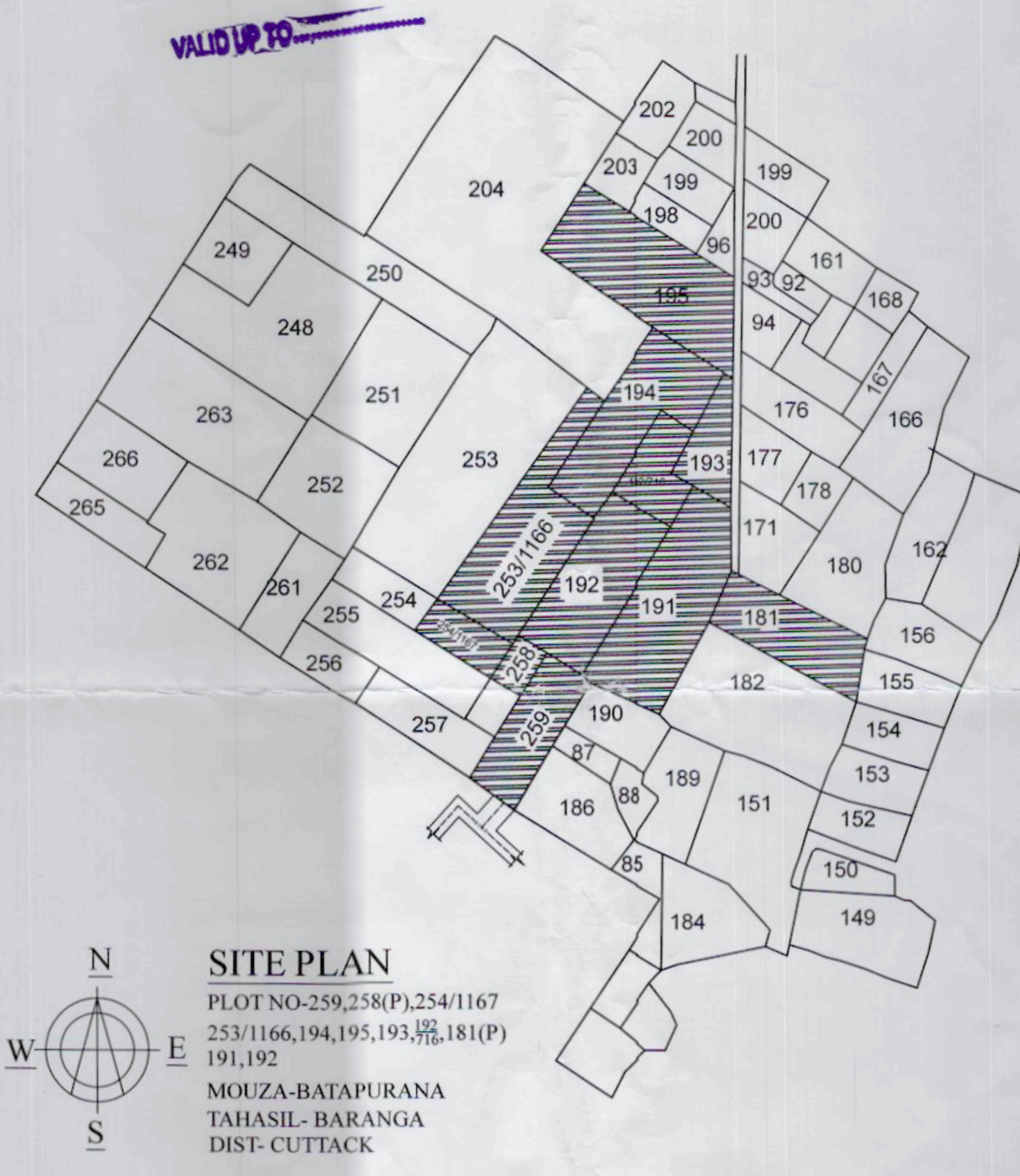

**SITE PLAN**  
 PLOT NO-259,258(P),254/1167  
 253/1166,194,195,193,181(P)  
 191,192  
 MOUZA-BATAPURANA  
 TAHASIL- BARANGA  
 DIST-CUTTACK

**LAND USE ANALYSIS**

REV PLOT NO	TOTAL AREA IN SQM	TOTAL AREA IN SQM (As per Document)	TOTAL AREA IN SQM (As per possession)	RESIDENTIAL AREA IN SQM	ROAD AREA IN SQM	OPEN SPACE AREA IN SQM	AMENITIES AREA IN SQM
195	A0.640	2590.92	2590.92	1487.38	807.45	296.09	NILL
194	A0.510	2064.64	2064.64	959.46	749.49	355.69	NILL
192/716	A0.190	769.18	769.18	360.83	339.59	NILL	68.76
193	A0.140	566.76	566.76	169.08	NILL	76.17	321.51
253/1166	A0.506	2048.45	2048.45	1266.79	738.56	43.10	NILL
254/1167	A0.094	380.54	380.54	290.16	90.38	NILL	NILL
258	A0.065	263.14	263.14	263.00	NILL	NILL	NILL
259	A0.300	1214.50	1214.50	254.69	564.20	395.61	NILL
192	A0.510	2064.64	2064.64	1356.26	708.38	NILL	NILL
191	A0.640	2590.92	2590.92	1460.94	740.85	NILL	389.13
181	A0.246	995.88	995.88	995.88	NILL	NILL	NILL
TOTAL	A0 3.841	15,549.57	15,549.57	8864.47	4738.90	1166.66	779.40

REV PLOT NO	REVISION	AREA IN SQM	TOTAL AREA IN SQM	PLANT	WEST	NORTH	SOUTH	PURPOSE
01	195	107.56	107.56	11.67	11.61	9.28	9.17	RESIDENTIAL
02	195	106.79	106.79	11.70	11.67	9.14	9.14	RESIDENTIAL
03	195	106.82	106.82	11.68	11.70	9.14	9.14	RESIDENTIAL
04	195	106.61	106.61	11.66	11.68	9.14	9.14	RESIDENTIAL
05	195	106.41	106.41	11.63	11.66	9.14	9.14	RESIDENTIAL
06	195	106.34	106.34	11.66	11.63	9.14	9.14	RESIDENTIAL
07	195	120.24	120.24	11.69	11.66	10.29	10.29	RESIDENTIAL
08	195	107.62	107.62	11.55	11.68	9.37	9.16	RESIDENTIAL
09	195	108.71	108.71	11.55	11.55	9.14	9.14	RESIDENTIAL
10	195	102.62	102.62	11.12	11.35	9.14	9.14	RESIDENTIAL
11	195	100.62	100.62	10.91	11.12	9.14	9.14	RESIDENTIAL
12	195	98.89	98.89	10.71	10.91	9.14	9.14	RESIDENTIAL
13	195	96.59	96.59	10.43	10.71	9.14	9.14	RESIDENTIAL
14	195	111.09	111.09	9.95	10.43	10.68	11.13	RESIDENTIAL
15	195	104.45	104.45	11.70	9.14	9.16	13.04	RESIDENTIAL
16	194	111.73	111.73	9.14	9.16	12.50	11.95	RESIDENTIAL
17	194	107.75	107.75	9.14	9.14	11.95	11.82	RESIDENTIAL
18	194	110.19	110.19	9.14	9.16	11.82	12.39	RESIDENTIAL
19	194	116.46	116.46	9.14	9.17	12.39	13.10	RESIDENTIAL
20	194	58.18	139.77	10.60	10.60	13.19	13.19	RESIDENTIAL
21	253/1166	81.56	120.51	9.14	9.14	13.19	13.19	RESIDENTIAL
22	194	4.66	120.51	9.14	9.14	13.19	13.19	RESIDENTIAL
23	253/1166	120.51	120.51	9.14	9.14	13.19	13.19	RESIDENTIAL
24	253/1166	120.51	120.51	9.14	9.14	13.19	13.19	RESIDENTIAL
25	253/1166	120.51	120.51	9.14	9.14	13.19	13.19	RESIDENTIAL
26	253/1166	120.51	120.51	9.14	9.14	13.19	13.19	RESIDENTIAL
27	253/1166	120.51	120.51	9.14	9.14	13.19	13.19	RESIDENTIAL
28	253/1166	120.51	120.51	9.14	9.14	13.19	13.19	RESIDENTIAL
29	254/1167	84.89	120.51	9.14	9.14	13.19	13.19	RESIDENTIAL
30	194	87.66	139.45	9.14	9.14	15.26	15.26	RESIDENTIAL
31	193	45.48	139.45	9.14	9.14	15.26	15.26	RESIDENTIAL
32	192/716	190.33	139.45	9.14	9.14	15.26	15.26	RESIDENTIAL
33	192/716	190.33	139.45	9.14	9.14	15.26	15.26	RESIDENTIAL
34	192/716	190.33	139.45	9.14	9.14	15.26	15.26	RESIDENTIAL
35	192	48.80	111.41	9.14	9.14	12.19	12.19	RESIDENTIAL
36	194	60.89	111.41	9.14	9.14	12.19	12.19	RESIDENTIAL
37	253/1166	59.18	111.41	9.14	9.14	12.19	12.19	RESIDENTIAL
38	192	22.22	111.41	9.14	9.14	12.19	12.19	RESIDENTIAL
39	253/1166	55.76	111.41	9.14	9.14	12.19	12.19	RESIDENTIAL
40	253/1166	54.04	111.41	9.14	9.14	12.19	12.19	RESIDENTIAL
41	253/1166	52.24	111.41	9.14	9.14	12.19	12.19	RESIDENTIAL
42	192	21.98	111.41	9.14	9.14	12.19	12.19	RESIDENTIAL
43	258	34.82	111.41	9.14	9.14	12.19	12.19	RESIDENTIAL
44	254/1167	32.37	111.41	9.14	9.14	12.19	12.19	RESIDENTIAL
45	254/1167	32.39	111.41	9.14	9.14	12.19	12.19	RESIDENTIAL
46	259	94.08	132.62	9.14	9.14	14.51	14.51	RESIDENTIAL
47	259	96.23	132.62	9.14	9.14	14.51	14.51	RESIDENTIAL
48	192	132.62	132.62	9.14	9.14	14.51	14.51	RESIDENTIAL
49	192	132.62	132.62	9.14	9.14	14.51	14.51	RESIDENTIAL
50	192	132.62	132.62	9.14	9.14	14.51	14.51	RESIDENTIAL
51	192	132.62	132.62	9.14	9.14	14.51	14.51	RESIDENTIAL
52	192	132.62	132.62	9.14	9.14	14.51	14.51	RESIDENTIAL
53	192	132.62	132.62	9.14	9.14	14.51	14.51	RESIDENTIAL
54	192	132.62	132.62	9.14	9.14	14.51	14.51	RESIDENTIAL
55	191	161.18	161.18	17.62	17.62	9.14	9.14	RESIDENTIAL
56	191	161.11	161.11	17.62	17.62	9.14	9.14	RESIDENTIAL
57	191	170.21	170.21	17.62	17.62	9.28	10.22	RESIDENTIAL
58	191	159.13	159.13	16.99	16.99	9.14	9.14	RESIDENTIAL
59	191	150.60	150.60	15.97	15.97	9.14	9.18	RESIDENTIAL
60	191	173.88	173.88	14.56	15.97	10.89	11.92	RESIDENTIAL
61	181	995.88	1614.20	24.51	23.49	62.12	66.58	RESIDENTIAL
62	192/716	68.76	779.40	AMENITIES AREA			AMENITIES AREA	
63	194	221.51	372.26	OPEN AREA			OPEN AREA	
64	194	355.69	398.79	OPEN AREA			OPEN AREA	
65	259	395.61	395.61	OPEN AREA			OPEN AREA	
66	195	807.45	4738.90	ROAD AREA			ROAD AREA	
TOTAL								



**CHECKED**  
 S. Draughtsman  
 Town Planning Unit, Cuttack

**AREA STATEMENT**

TOTAL PLOT AREA-15549.57 SQMT AS PER DOCUMENT  
 TOTAL PLOT AREA-15549.57 SQMT AS PER POSSESSION

**LAND USE ANALYSIS**

SL. NO.	USE	REQUIRED AREA	PROVIDED
1	RESIDENTIAL	8864.47 sqmt(57.00%)	8864.47 sqmt(57.00%)
2	AMENITIES	779.47 sqmt(5.00%)	779.40 sqmt(5.01%)
3	OPEN SPACE	1166.21 sqmt(7.5%)	1166.66 sqmt(7.50%)
4	ROAD	4738.90sqmt(30.47%)	4738.90sqmt(30.47%)
TOTAL		15549.57 sqmt(100.00%)	15449.43 sqmt(99.98%)

TOTAL NO. OF SUB-DIVISION PLOTS = 68 NOS.  
 TOTAL NO. OF RESIDENTIAL SUB-DIVISION PLOTS = 62 NOS.  
 TOTAL NO. OF TREES = 195 NOS.

**PROJECT TITLE**  
 Proposed Sub Divisional Layout Plan For M/S Krishna Properties & Developers Pvt.Ltd. Represented Through Its Director Mr. Debi Prasad Mahapatra Over Revenue Plot No -192/716,Khata no-382/291,Plot No-194,Khata No-382/292,Plot No-259,Khata No-382/290,Plot No-193, Khata No-382/328,Plot No-258,Khata No-216,Plot No-195,Khata No-382/327,Plot No-191, Khata No-382/300,Plot No-181,Khata No-49,Plot No-253/1166,Khata No-382/302,Plot No-254/1167,Khata No-382/302, Plot No-192,Khata No-382/334 of Mouza -Batapurana, Tahasil- Cuttack, Tahasil- Baranga, Dist -Cuttack

**DRAWING TITLE** SUB DIVISIONAL LAY-OUT APPROVAL

**APPLICANT** M/S KRISHNA PROPERTIES & DEVELOPERS PVT.LTD.  
 Mr. Debi Prasad Mahapatra, Director  
 M/S KRISHNA PROPERTIES & DEVELOPERS PVT. LTD.

**PREPARED BY** AVANT GARDE DESIGNERS  
 Architecture Planning Interiors  
 302,2nd, Jagannath Tower, Ashok nagar  
 BHUBANESWAR  
 Email: avantgardeinteriors@gmail.com  
 Phone: no-0674-286476

**ARCHITECT** A-MANISH KUMAR AGRAWAL  
 Registered Architect  
 Regd.No. -CA-972353  
 BDA Regd.No.-AR/250/BDA

**PLOTTING LAYOUT PLAN**  
 SCALE-1:50