

**SCHEDULE OF DOORS & WINDOWS**

Sl. No.	Type	Quantity	Description
1	D	14732.13	Painted door
2	DI	64922.13	Painted door
3	DI	64922.13	Painted door
4	W	14732.13	Painted window
5	W	14732.13	Painted window
6	W	14732.13	Painted window
7	W	14732.13	Painted window
8	W	14732.13	Painted window
9	V	64922.13	Painted vent
10	V	14732.13	Painted vent

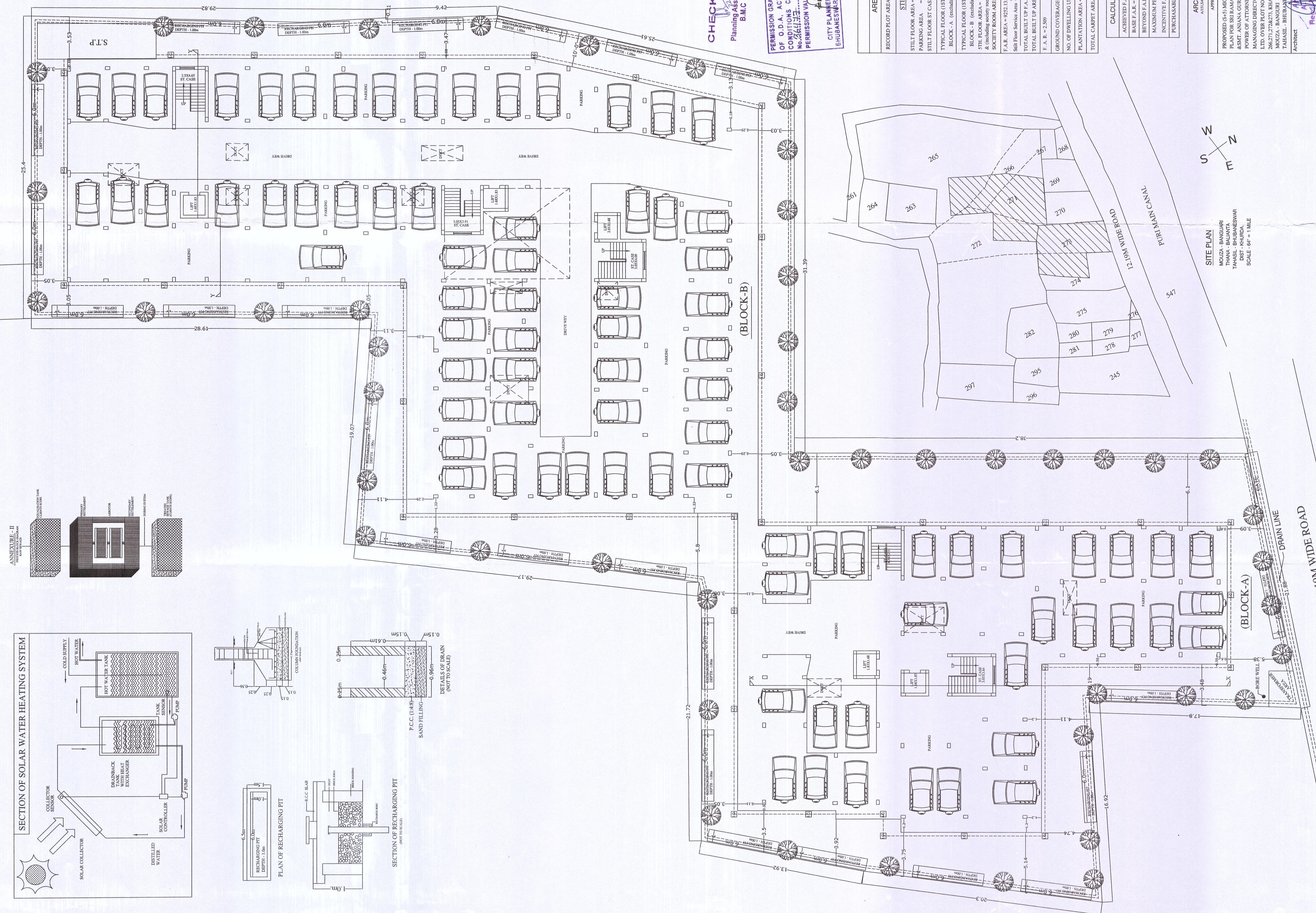

**CHECKED**  
 Planning Assistant  
 B.M.C.

PERMISSION GRANTED UNDER SEC. 18(1) OF O.D.A. ACT, 1982 SUBJECT TO CONDITIONS CONTAINED IN THE PERMITS. DATE: 21/07/2022. No. 266/11/2022. PERMISSION VALID UP TO 21/07/2025.

*[Signature]*  
 CITY PLANNER  
 BHUBANESHWAR MUNICIPAL CORPORATION

**SHEET NO. - AP/07/19**

**AREA STATEMENT**

RECORD PLOT AREA = 372.076 SQM.

**STILT FLOOR PLAN**

STILT FLOOR AREA = 2446.61 SQM. (BLOCK - A & B)

PARKING AREA = 256.67 SQM. (33.2%)

STILT FLOOR ST. CASE & LIFT AREA = 91.975 SQM. (BLOCK-A&B)

TYPICAL FLOOR (1ST. TO 4TH) AREA = 682.24X5=3411.27 SQM.

BLOCK - A (excluding lift area)

TYPICAL FLOOR (1ST. TO 4TH) AREA = 1224.172X4=4896.675 SQM.

BLOCK - B (excluding lift area)

17th FLOOR AREA = 1224.173 SQM. (excluding lift area)

& SOCIETY ROOM AREA = 89.88 SQM. (excluding lift area)

F.A.R. AREA = 9252.135 SQM. (1st-2nd-3rd-4th-5th Floor Area)

Stilt Floor Service Area = 91.973 SQM. (of case & lift Area)

TOTAL BUILT UP F.A.R. AREA = 9344.108 SQM.

TOTAL BUILT UP AREA = 11700.745 SQM.

F. A. R. = 2.309

GROUND COVERAGE = 63.76 %

NO. OF DWELLING UNIT = 84 NOS

PLANTATION AREA = 46 NOS TREES

TOTAL CARPET AREA = 1497.7 X 5 = 7186.5 SQM.

**CALCULATION OF INCENTIVE F.A.R.**

ACHIEVED F.A.R. = 2.309

BASE F.A.R. = 2

BEYOND F.A.R. = 0.509

MAXIMUM PERMISSIBLE INCENTIVE F.A.R. = 0.25

PURCHASABLE F.A.R. = 0.259

967.187 SQM.

**ARCHITECTS POINT**  
 APPROVAL DRAWING

PROPOSED (5-6) MID RESIDENTIAL APARTMENT BUILDING PLAN FOR SRI RAMAKANTA MISRA, SMT. AJANTA MISRA & SMT. ANJANA GIRI, REPRESENTED BY GENERAL POWER OF ATTORNEY HOLDER SRI BIJAY KUMAR PATRA, MANAGING DIRECTOR OF M.S. OMMBASTU BUILDCON PVT. LTD. OVER PLOT NO. 272/103,365/104/272/107,266/103&274, 266-271,272&273, KHATA NO. - 330297,330298,330299,330300,330301,330302,330303,330304,330305,330306,330307,330308,330309,330310,330311,330312,330313,330314,330315,330316,330317,330318,330319,330320,330321,330322,330323,330324,330325,330326,330327,330328,330329,330330,330331,330332,330333,330334,330335,330336,330337,330338,330339,330340,330341,330342,330343,330344,330345,330346,330347,330348,330349,330350,330351,330352,330353,330354,330355,330356,330357,330358,330359,330360,330361,330362,330363,330364,330365,330366,330367,330368,330369,330370,330371,330372,330373,330374,330375,330376,330377,330378,330379,330380,330381,330382,330383,330384,330385,330386,330387,330388,330389,330390,330391,330392,330393,330394,330395,330396,330397,330398,330399,330400,330401,330402,330403,330404,330405,330406,330407,330408,330409,330410,330411,330412,330413,330414,330415,330416,330417,330418,330419,330420,330421,330422,330423,330424,330425,330426,330427,330428,330429,330430,330431,330432,330433,330434,330435,330436,330437,330438,330439,330440,330441,330442,330443,330444,330445,330446,330447,330448,330449,330450,330451,330452,330453,330454,330455,330456,330457,330458,330459,330460,330461,330462,330463,330464,330465,330466,330467,330468,330469,330470,330471,330472,330473,330474,330475,330476,330477,330478,330479,330480,330481,330482,330483,330484,330485,330486,330487,330488,330489,330490,330491,330492,330493,330494,330495,330496,330497,330498,330499,330500,330501,330502,330503,330504,330505,330506,330507,330508,330509,330510,330511,330512,330513,330514,330515,330516,330517,330518,330519,330520,330521,330522,330523,330524,330525,330526,330527,330528,330529,330530,330531,330532,330533,330534,330535,330536,330537,330538,330539,330540,330541,330542,330543,330544,330545,330546,330547,330548,330549,330550,330551,330552,330553,330554,330555,330556,330557,330558,330559,330560,330561,330562,330563,330564,330565,330566,330567,330568,330569,330570,330571,330572,330573,330574,330575,330576,330577,330578,330579,330580,330581,330582,330583,330584,330585,330586,330587,330588,330589,330590,330591,330592,330593,330594,330595,330596,330597,330598,330599,330600,330601,330602,330603,330604,330605,330606,330607,330608,330609,330610,330611,330612,330613,330614,330615,330616,330617,330618,330619,330620,330621,330622,330623,330624,330625,330626,330627,330628,330629,330630,330631,330632,330633,330634,330635,330636,330637,330638,330639,330640,330641,330642,330643,330644,330645,330646,330647,330648,330649,330650,330651,330652,330653,330654,330655,330656,330657,330658,330659,330660,330661,330662,330663,330664,330665,330666,330667,330668,330669,330670,330671,330672,330673,330674,330675,330676,330677,330678,330679,330680,330681,330682,330683,330684,330685,330686,330687,330688,330689,330690,330691,330692,330693,330694,330695,330696,330697,330698,330699,330700,330701,330702,330703,330704,330705,330706,330707,330708,330709,330710,330711,330712,330713,330714,330715,330716,330717,330718,330719,330720,330721,330722,330723,330724,330725,330726,330727,330728,330729,330730,330731,330732,330733,330734,330735,330736,330737,330738,330739,330740,330741,330742,330743,330744,330745,330746,330747,330748,330749,330750,330751,330752,330753,330754,330755,330756,330757,330758,330759,330760,330761,330762,330763,330764,330765,330766,330767,330768,330769,330770,330771,330772,330773,330774,330775,330776,330777,330778,330779,330780,330781,330782,330783,330784,330785,330786,330787,330788,330789,330790,330791,330792,330793,330794,330795,330796,330797,330798,330799,330800,330801,330802,330803,330804,330805,330806,330807,330808,330809,330810,330811,330812,330813,330814,330815,330816,330817,330818,330819,330820,330821,330822,330823,330824,330825,330826,330827,330828,330829,330830,330831,330832,330833,330834,330835,330836,330837,330838,330839,330840,330841,330842,330843,330844,330845,330846,330847,330848,330849,330850,330851,330852,330853,330854,330855,330856,330857,330858,330859,330860,330861,330862,330863,330864,330865,330866,330867,330868,330869,330870,330871,330872,330873,330874,330875,330876,330877,330878,330879,330880,330881,330882,330883,330884,330885,330886,330887,330888,330889,330890,330891,330892,330893,330894,330895,330896,330897,330898,330899,330900,330901,330902,330903,330904,330905,330906,330907,330908,330909,330910,330911,330912,330913,330914,330915,330916,330917,330918,330919,330920,330921,330922,330923,330924,330925,330926,330927,330928,330929,330930,330931,330932,330933,330934,330935,330936,330937,330938,330939,330940,330941,330942,330943,330944,330945,330946,330947,330948,330949,330950,330951,330952,330953,330954,330955,330956,330957,330958,330959,330960,330961,330962,330963,330964,330965,330966,330967,330968,330969,330970,330971,330972,330973,330974,330975,330976,330977,330978,330979,330980,330981,330982,330983,330984,330985,330986,330987,330988,330989,330990,330991,330992,330993,330994,330995,330996,330997,330998,330999,331000,331001,331002,331003,331004,331005,331006,331007,331008,331009,331010,331011,331012,331013,331014,331015,331016,331017,331018,331019,331020,331021,331022,331023,331024,331025,331026,331027,331028,331029,331030,331031,331032,331033,331034,331035,331036,331037,331038,331039,331040,331041,331042,331043,331044,331045,331046,331047,331048,331049,331050,331051,331052,331053,331054,331055,331056,331057,331058,331059,331060,331061,331062,331063,331064,331065,331066,331067,331068,331069,331070,331071,331072,331073,331074,331075,331076,331077,331078,331079,331080,331081,331082,331083,331084,331085,331086,331087,331088,331089,331090,331091,331092,331093,331094,331095,331096,331097,331098,331099,331100,331101,331102,331103,331104,331105,331106,331107,331108,331109,331110,331111,331112,331113,331114,331115,331116,331117,331118,331119,331120,331121,331122,331123,331124,331125,331126,331127,331128,331129,331130,331131,331132,331133,331134,331135,331136,331137,331138,331139,331140,331141,331142,331143,331144,331145,331146,331147,331148,331149,331150,331151,331152,331153,331154,331155,331156,331157,331158,331159,331160,331161,331162,331163,331164,331165,331166,331167,331168,331169,331170,331171,331172,331173,331174,331175,331176,331177,331178,331179,331180,331181,331182,331183,331184,331185,331186,331187,331188,331189,331190,331191,331192,331193,331194,331195,331196,331197,331198,331199,331200,331201,331202,331203,331204,331205,331206,331207,331208,331209,331210,331211,331212,331213,331214,331215,331216,331217,331218,331219,331220,331221,331222,331223,331224,331225,331226,331227,331228,331229,331230,331231,331232,331233,331234,331235,331236,331237,331238,331239,331240,331241,331242,331243,331244,331245,331246,331247,331248,331249,331250,331251,331252,331253,331254,331255,331256,331257,331258,331259,331260,331261,331262,331263,331264,331265,331266,331267,331268,331269,331270,331271,331272,331273,331274,331275,331276,331277,331278,331279,331280,331281,331282,331283,331284,331285,331286,331287,331288,331289,331290,331291,331292,331293,331294,331295,331296,331297,331298,331299,331300,331301,331302,331303,331304,331305,331306,331307,331308,331309,331310,331311,331312,331313,331314,331315,331316,331317,331318,331319,331320,331321,331322,331323,331324,331325,331326,331327,331328,331329,331330,331331,331332,331333,331334,331335,331336,331337,331338,331339,331340,331341,331342,331343,331344,331345,331346,331347,331348,331349,331350,331351,331352,331353,331354,331355,331356,331357,331358,331359,331360,331361,331362,331363,331364,331365,331366,331367,331368,331369,331370,331371,331372,331373,331374,331375,331376,331377,331378,331379,331380,331381,331382,331383,331384,331385,331386,331387,331388,331389,331390,331391,331392,331393,331394,331395,331396,331397,331398,331399,331400,331401,331402,331403,331404,331405,331406,331407,331408,331409,331410,331411,331412,331413,331414,331415,331416,331417,331418,331419,331420,331421,331422,331423,331424,331425,331426,331427,331428,331429,331430,331431,331432,331433,331434,331435,331436,331437,331438,331439,331440,331441,331442,331443,331444,331445,331446,331447,331448,331449,331450,331451,331452,331453,331454,331455,331456,331457,331458,331459,331460,331461,331462,331463,331464,331465,331466,331467,331468,331469,331470,331471,331472,331473,331474,331475,331476,331477,331478,331479,331480,331481,331482,331483,331484,331485,331486,331487,331488,331489,331490,331491,331492,331493,331494,331495,331496,331497,331498,331499,331500,331501,331502,331503,331504,331505,331506,331507,331508,331509,331510,331511,331512,331513,331514,331515,331516,331517,331518,331519,331520,331521,331522,331523,331524,331525,331526,331527,331528,331529,331530,331531,331532,331533,331534,331535,331536,331537,331538,331539,331540,331541,331542,331543,331544,331545,331546,331547,331548,331549,331550,331551,331552,331553,331554,331555,331556,331557,331558,331559,331560,331561,331562,331563,331564,331565,331566,331567,331568,331569,331570,331571,331572,331573,331574,331575,331576,331577,331578,331579,331580,331581,331582,331583,331584,331585,331586,331587,331588,331589,331590,331591,331592,331593,331594,331595,331596,331597,331598,331599,331600,331601,331602,331603,331604,331605,331606,331607,331608,331609,331610,331611,331612,331613,331614,331615,331616,331617,331618,331619,331620,331621,331622,331623,331624,331625,331626,331627,331628,331629,331630,331631,331632,331633,331634,331635,331636,331637,331638,331639,331640,331641,331642,331643,331644,331645,331646,331647,331648,331649,331650,331651,331652,331653,331654,331655,331656,331657,331658,331659,331660,331661,331662,331663,331664,331665,331666,331667,331668,331669,331670,331671,331672,331673,331674,331675,331676,331677,331678,331679,331680,331681,331682,331683,331684,331685,331686,331687,331688,331689,331690,331691,331692,331693,331694,331695,331696,331697,331698,331699,331700,331701,331702,331703,331704,331705,331706,331707,331708,331709,331710,331711,331712,331713,331714,331715,331716,331717,331718,331719,331720,331721,331722,331723,331724,331725,331726,331727,331728,331729,331730,331731,331732,331733,331734,331735,331736,331737,331738,331739,331740,331741,331742,331743,331744,331745,331746,331747,331748,331749,331750,331751,331752,331753,331754,331755,331756,331757,331758,331759,331760,331761,331762,331763,331764,331765,331766,331767,331768,331769,331770,331771,331772,331773,331774,331775,331776,331777,331778,331779,331780,331781,331782,331783,331784,331785,331786,331787,331788,331789,331790,331791,331792,331793,331794,331795,331796,331797,331798,331799,331800,331801,331802,331803,331804,331805,331806,331807,331808,331809,331810,331811,331812,33181