

ନିୟମ ସିଟ ନଂ ୪

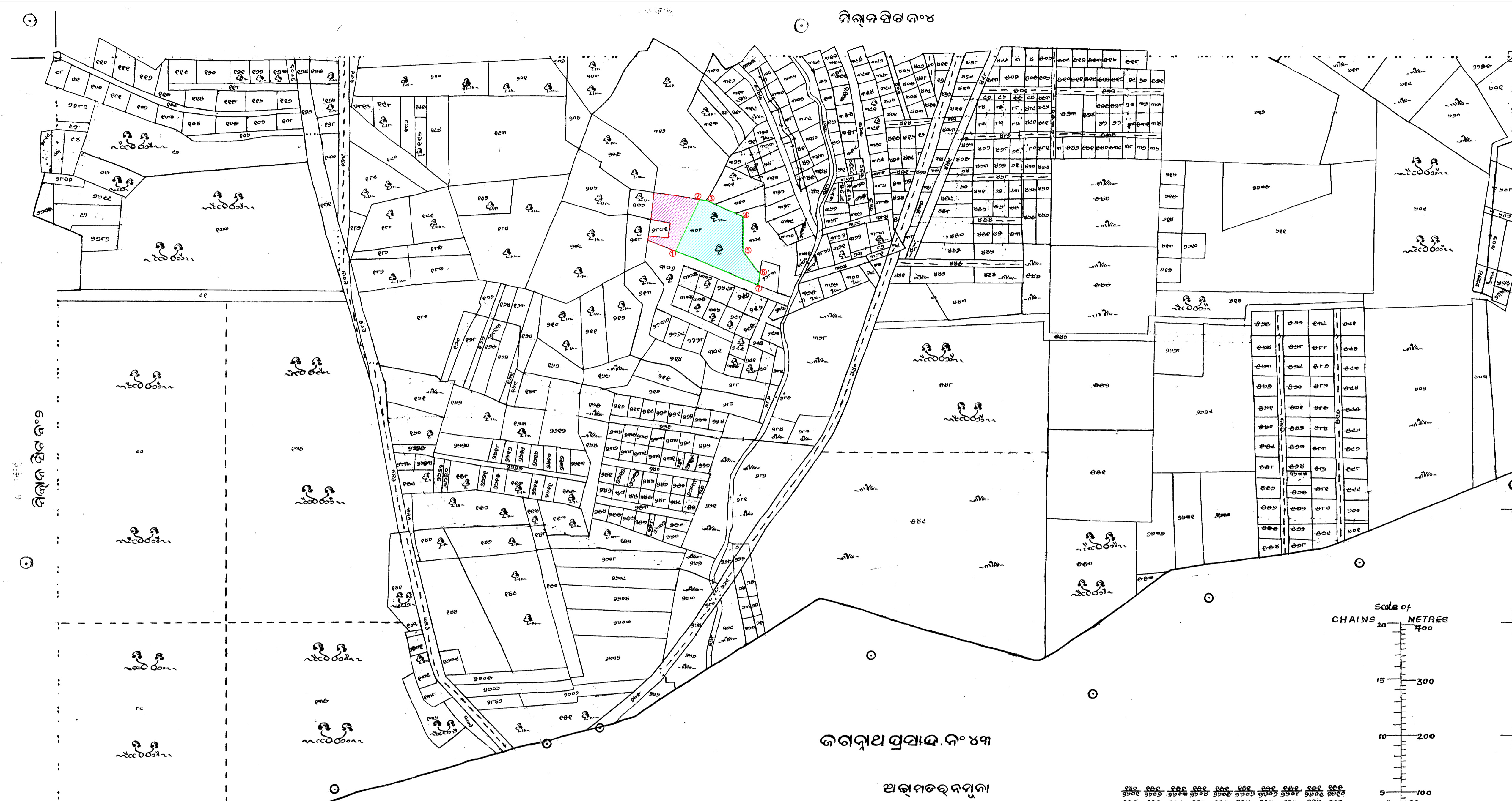

SL. NO.	LONGITUDE	LATITUDE
1	20°20'58.7" N	85°46'17.5" E
2	20°21'00.4" N	85°46'18.3" E
3	20°21'00.4" N	85°46'18.6" E
4	20°21'00.0" N	85°46'19.7" E
5	20°20'59.1" N	85°46'19.7" E
6	20°20'58.4" N	85°46'20.2" E
7	20°20'58.1" N	85°46'20.0" E

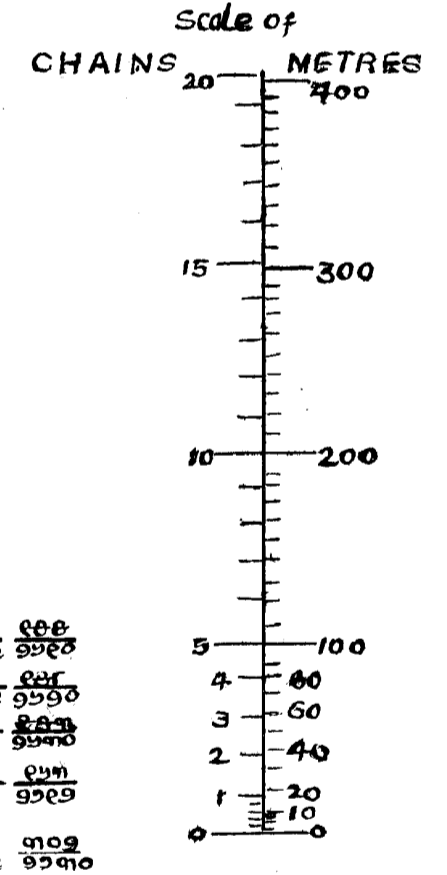

ଜଗନ୍ନାଥ ପ୍ରସାଦ ନଂ ୪୩

ଆକାମତର ନମୁନା

ସରକାରୀ ଚିହ୍ନ, ପୁସ୍ତକାଳୟ ଚିହ୍ନ	⊕ ⊙
ରୋଡ୍ ନେକ ନଂ ୩ ଓ ଖାଲି ଚିହ୍ନ	— —
ଗ୍ରାମ୍ୟ ଚିହ୍ନ	୨ ୩
ଆକାମତର	୨ ୩
ଗ୍ରାମ୍ୟ ରସ୍ତା, ଘର	— —
ତ୍ରିସିମାଳୀ, ଦୋସିମାଳୀ	Δ ○

ଏହି ମାପ ଉପରେ ଉଲ୍ଲେଖ କରାଯାଇଥିବା ସମସ୍ତ ବିବରଣୀ ସତ୍ୟ ଓ ଠିକ୍ ଅଟେ ଏବଂ ଏହା ଉପରେ କୌଣସି ପରିବର୍ତ୍ତନ କରାଯାଇ ନାହିଁ। ଏହା ଉପରେ କୌଣସି ପରିବର୍ତ୍ତନ କରାଯାଇ ନାହିଁ। ଏହା ଉପରେ କୌଣସି ପରିବର୍ତ୍ତନ କରାଯାଇ ନାହିଁ।

N ମୌଜା ସୁନ୍ଦରପୁର ସିଟ ନଂ ୩
 ଥାନା ଚନ୍ଦକା ନଂ ୪୧
 ଚତୁର୍ଥ ଲୁକନେଶ୍ୱର ନଂ ୪୧
 SUNDARPUR, SHEET No.3
 Thana Chandaka No.41
ଜିଲ୍ଲା ଖୋର୍ଦ୍ଧା
 ସ୍କେଲ ୧: ୨୦୦୦ Scale 1: 2000
 ସନ ୨୦୧୩-୧୪ Year 2013-14

NOTES:-

PLOT IN POSSESSION

PLOT NOT IN POSSESSION

Certified that this map has been finally framed and a copy of it has been finally published in accordance with rule 29 and read with rule 60 of O.S & S Rules, 1962 on 23rd September 2013.

[Signature]
 Settlement Officer

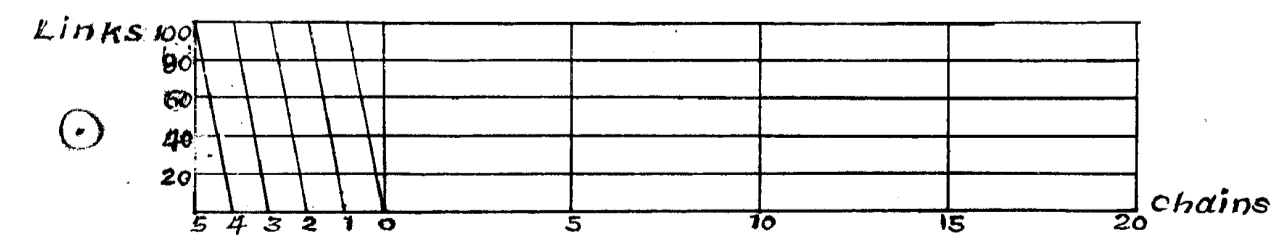

PROPOSED RESIDENTIAL LAYOUT PLAN OF SRI PRAFULLA SAMANTARAY, SRI PRAHALADA SAMANTARAY, SRI PITABASA SAMANTARAY OVER PLOT NO.-308, KHATA NO.- 890/322, REPRESENTED BY P.O.A. SUBASINI BUILDERS THROUGH IT'S MD MR. RASBIHARI PRADHAN MOUZA- SUNDARPUR, BHUBANESWAR DIST-KHORDHA.