

ମୌଜା ରୁଦ୍ରପୁର

ଥାନା ବାଲିଆପାଟଣା ନଂ ୧୩
 ଚତୁର୍ଥ ଉପନିକ୍ଷେପ ନଂ ୨୯୭

RUDRA PUR
 Thana Balia Patana No 13

ଜିଲ୍ଲା ପୁସ୍ତକ

ସ୍କେଲ ୧:୨୫୦୦୦
 Scale 1:25000
 ଉପ ୧୯୯୯-୨୦ Year 1979-80

Scale of
 CHAINS METRES

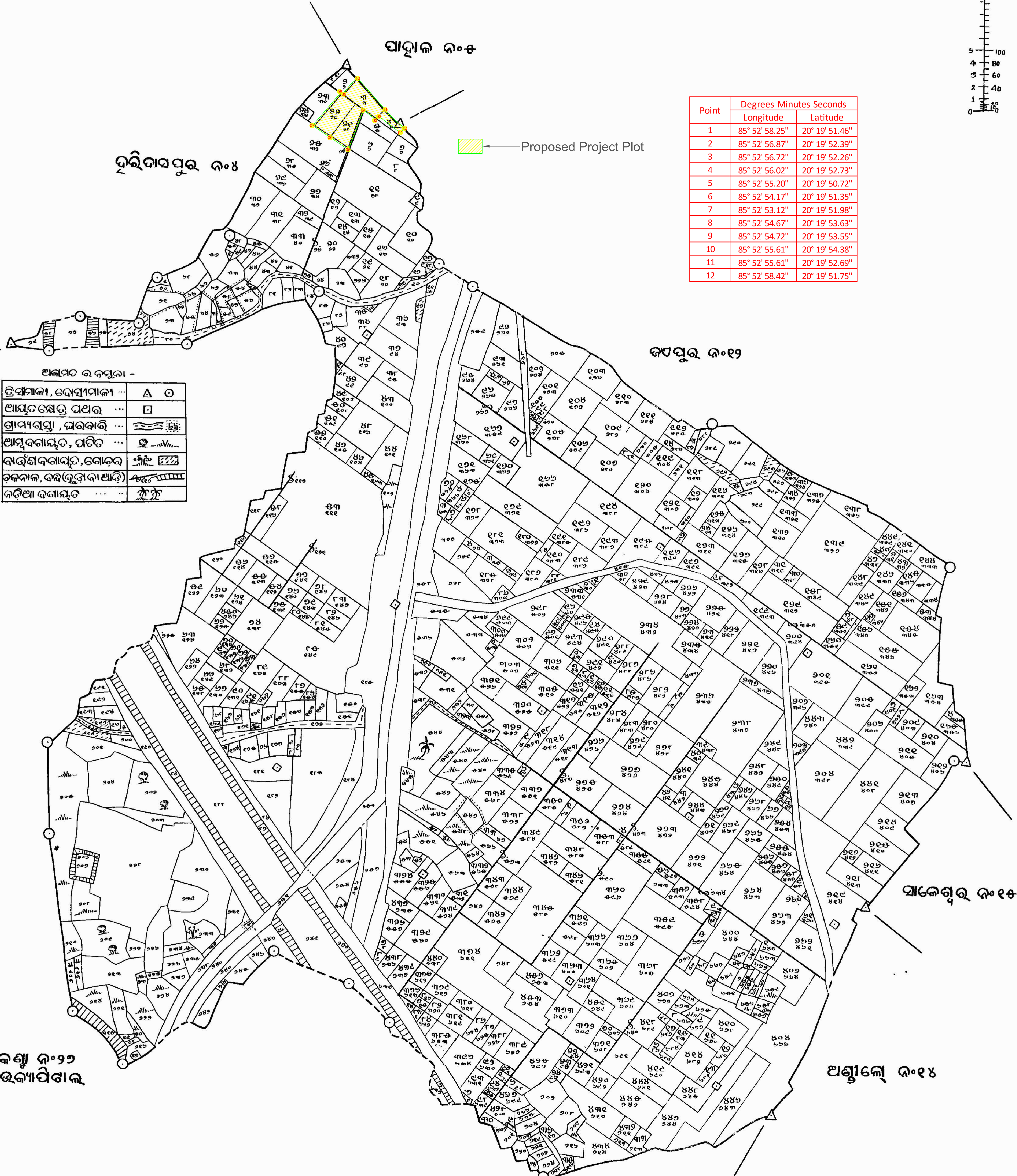
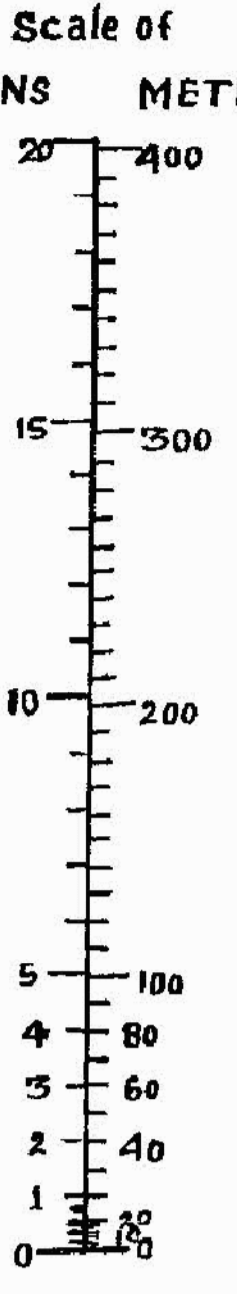

Point	Degrees Minutes Seconds	
	Longitude	Latitude
1	85° 52' 58.25"	20° 19' 51.46"
2	85° 52' 56.87"	20° 19' 52.39"
3	85° 52' 56.72"	20° 19' 52.26"
4	85° 52' 56.02"	20° 19' 52.73"
5	85° 52' 55.20"	20° 19' 50.72"
6	85° 52' 54.17"	20° 19' 51.35"
7	85° 52' 53.12"	20° 19' 51.98"
8	85° 52' 54.67"	20° 19' 53.63"
9	85° 52' 54.72"	20° 19' 53.55"
10	85° 52' 55.61"	20° 19' 54.38"
11	85° 52' 55.61"	20° 19' 52.69"
12	85° 52' 58.42"	20° 19' 51.75"

ଅଙ୍କିତ ଚିହ୍ନସୂଚୀ -

ଘାଟିଆ, ଘାଟିଆ	△ ○
ଆସିତ କ୍ଷେତ୍ର ଘାଟ	□
ଗ୍ରାମୀଣସ୍ତମ୍ଭ, ଘରଘାଟ	⊠
ଆସିତ କ୍ଷେତ୍ର, ପରିଚିତ	⊡
ବାଣିଜ୍ୟ କୋଷ, ଗୋଦଳ	⊞
ବଜାର, ବନ୍ଧୁକୋଷ ଆଢ଼ି	⊠
ନିର୍ଦ୍ଦିଷ୍ଟ କୋଷ	⊞

ନିର୍ଦ୍ଦେଶକ ନଂ ୨୨
 ଥାନା ଉପନିକ୍ଷେପ

କର୍ତ୍ତବ୍ୟ ଆଧୁନିକ କା ୧୧୪.୫.୧୦ ଲିଖିତ ଆଦେଶମତେ ବକ ନଂ ୮୫, ୩୫୦, ୩୫୧, ୪୦୩, ୫୦୭
 ଚୁକ୍ତି ନଂ ୧୫୮, ୫୨୨, ୫୨୨, ୨୨୫ ଓ ୨୨୧ ଉକ୍ତ ନିକ୍ଷେପରେ ଲେଖା କରାଯାଇଛି ।

କର୍ତ୍ତବ୍ୟ ନିକ୍ଷେପ ନଂ ୨୨
 ଚୁକ୍ତି ନଂ ୧୫୮, ୫୨୨, ୫୨୨, ୨୨୫ ଓ ୨୨୧

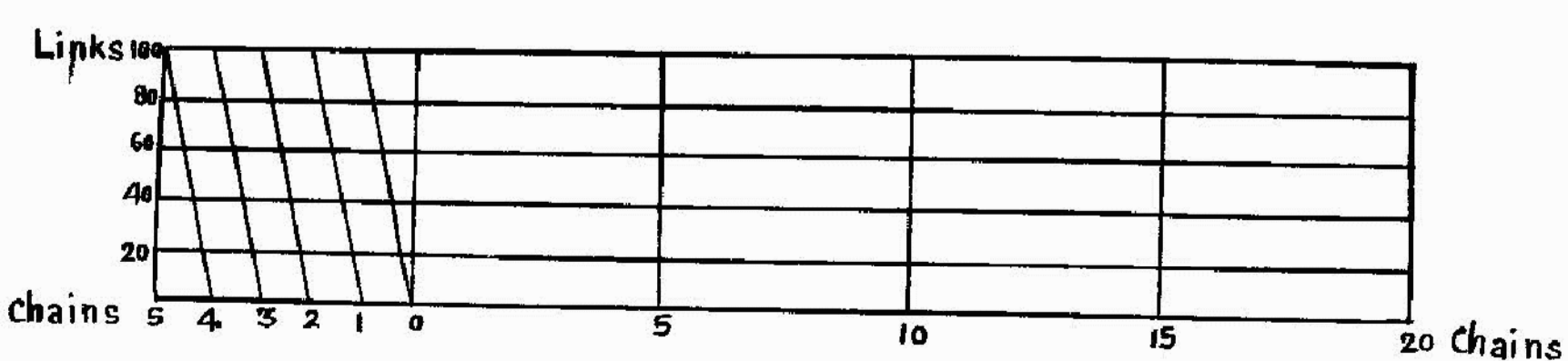

Certified that this map which has been finally prepared under sub-section (1) of section 22 of the orissa consolidation of holdings and prevention of fragmentation of Land Act 1972 has been finally published in accordance with the provision contained in sub section (2) of the side section read with rule 26 of the orissa consolidation of holdings and prevention of fragmentation of Land rules, 1973 on

Asst. Consolidation Officer,
 Balia Patana Circle.