

# ମୌଜା ରୁଦ୍ରପୁର

ଥାନା ବାଲିଆନ୍ତା ନଂ ୧୩  
ଡିଭିଜନ ଭୁବନେଶ୍ୱର ନଂ ୧୯୨

RUDRA PUR  
Thana' Baliañta No 13

## ଜିଲ୍ଲା ପୁରୀ

ସ୍କେଲ ୧:୧୨୫୦୦ = ୧ ଇଞ୍ଚ = ୧ ମାଇଲ Scale 1:12500  
୧୯୭୯-୮୦ Year 1979-80

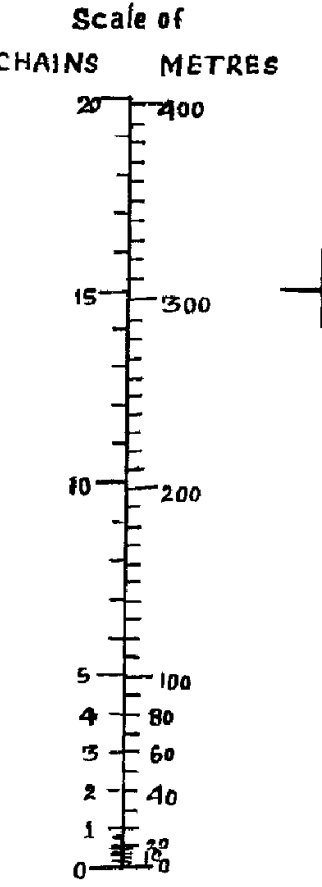

SL. NO.	LATITUDE	LONGITUDE
1	20°19'04.0" N	85°52'59.2" E
2	20°19'04.4" N	85°52'59.5" E
3	20°19'04.5" N	85°52'59.4" E
4	20°19'05.3" N	85°53'00.0" E
5	20°19'06.2" N	85°53'00.7" E
6	20°19'05.3" N	85°53'02.0" E
7	20°19'04.5" N	85°53'01.5" E
8	20°19'03.6" N	85°53'00.8" E
9	20°19'04.1" N	85°53'00.1" E
10	20°19'03.4" N	85°52'59.4" E

ଅଲୀମତ ର ନମୁନା -

ଦିଗ୍‌ସୀଳା, ଦେସୀମାଳା ...	△ ○
ଆୟତକ୍ଷେତ୍ର ପଥର ...	□
ଗାମ୍ଭୀରସ୍ତ, ଘରବାଡ଼ି ...	▭
ଆୟତକୋଣ, ଗଡ଼ିତ ...	▭
ବାଉଁଶିଦଗାୟା, ଗୋଦବ ...	▭
ଚକ୍ରାକା, କଳ(କୂଳି ବା ଆଡ଼ି) ...	⊙
ନଦିଆ ଦଗାୟା ...	~

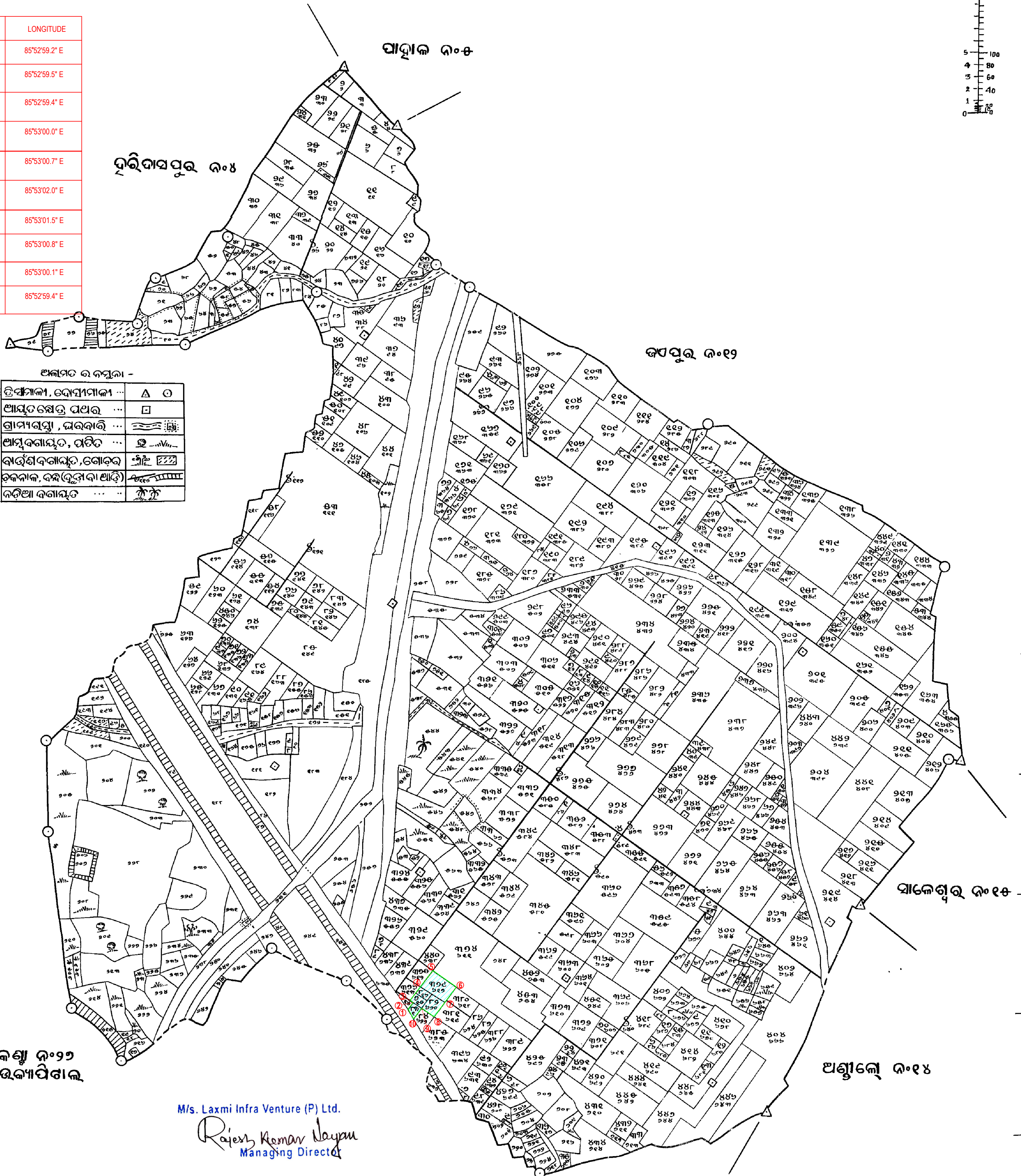

ନଦୁରକଣ୍ଠା ନଂ ୨୨  
ଥାନା ନିଉକୋପିଟାଲ

M/s. Laxmi Infra Venture (P) Ltd.

Rajesh Kumar Nayak  
Managing Director

ଦଳବଳୀ ଅଧିକାରୀଙ୍କ ଦ୍ୱାରା ୧୯୮୫-୮୦ ରେ ଆବେଦନ କରାଯାଇଥିବା କ୍ଷେତ୍ର ନଂ ୮୪, ୩୪୦, ୩୪୧, ୪୦୩, ୪୦୪  
ପୂର୍ବ ନଂ ୧୫୮, ୧୬୨, ୧୬୩, ୨୨୫ ଓ ୨୨୬ ରେ ମୌଜାରୁ ଲେଉଟ କରାଯାଇଛି ।

ଦଳବଳୀ  
ପୂର୍ବବଳୀ

୩୨୭	୩୨୮	୩୨୯	୩୩୦	୩୩୧	୩୩୨	୩୩୩	୩୩୪	୩୩୫	୩୩୬	୩୩୭	୩୩୮	୩୩୯	୩୪୦	୩୪୧	୩୪୨	୩୪୩	୩୪୪	୩୪୫	୩୪୬	୩୪୭	୩୪୮	୩୪୯	୩୫୦	୩୫୧	୩୫୨	୩୫୩	୩୫୪	୩୫୫	୩୫୬	୩୫୭	୩୫୮	୩୫୯	୩୬୦	୩୬୧	୩୬୨	୩୬୩	୩୬୪	୩୬୫	୩୬୬	୩୬୭	୩୬୮	୩୬୯	୩୭୦	୩୭୧	୩୭୨	୩୭୩	୩୭୪	୩୭୫	୩୭୬	୩୭୭	୩୭୮	୩୭୯	୩୮୦	୩୮୧	୩୮୨	୩୮୩	୩୮୪	୩୮୫	୩୮୬	୩୮୭	୩୮୮	୩୮୯	୩୯୦	୩୯୧	୩୯୨	୩୯୩	୩୯୪	୩୯୫	୩୯୬	୩୯୭	୩୯୮	୩୯୯	୪୦୦	୪୦୧	୪୦୨	୪୦୩	୪୦୪	୪୦୫	୪୦୬	୪୦୭	୪୦୮	୪୦୯	୪୧୦	୪୧୧	୪୧୨	୪୧୩	୪୧୪	୪୧୫	୪୧୬	୪୧୭	୪୧୮	୪୧୯	୪୨୦	୪୨୧	୪୨୨	୪୨୩	୪୨୪	୪୨୫	୪୨୬	୪୨୭	୪୨୮	୪୨୯	୪୩୦	୪୩୧	୪୩୨	୪୩୩	୪୩୪	୪୩୫	୪୩୬	୪୩୭	୪୩୮	୪୩୯	୪୪୦	୪୪୧	୪୪୨	୪୪୩	୪୪୪	୪୪୫	୪୪୬	୪୪୭	୪୪୮	୪୪୯	୪୫୦	୪୫୧	୪୫୨	୪୫୩	୪୫୪	୪୫୫	୪୫୬	୪୫୭	୪୫୮	୪୫୯	୪୬୦	୪୬୧	୪୬୨	୪୬୩	୪୬୪	୪୬୫	୪୬୬	୪୬୭	୪୬୮	୪୬୯	୪୭୦	୪୭୧	୪୭୨	୪୭୩	୪୭୪	୪୭୫	୪୭୬	୪୭୭	୪୭୮	୪୭୯	୪୮୦	୪୮୧	୪୮୨	୪୮୩	୪୮୪	୪୮୫	୪୮୬	୪୮୭	୪୮୮	୪୮୯	୪୯୦	୪୯୧	୪୯୨	୪୯୩	୪୯୪	୪୯୫	୪୯୬	୪୯୭	୪୯୮	୪୯୯	୫୦୦
-----	-----	-----	-----	-----	-----	-----	-----	-----	-----	-----	-----	-----	-----	-----	-----	-----	-----	-----	-----	-----	-----	-----	-----	-----	-----	-----	-----	-----	-----	-----	-----	-----	-----	-----	-----	-----	-----	-----	-----	-----	-----	-----	-----	-----	-----	-----	-----	-----	-----	-----	-----	-----	-----	-----	-----	-----	-----	-----	-----	-----	-----	-----	-----	-----	-----	-----	-----	-----	-----	-----	-----	-----	-----	-----	-----	-----	-----	-----	-----	-----	-----	-----	-----	-----	-----	-----	-----	-----	-----	-----	-----	-----	-----	-----	-----	-----	-----	-----	-----	-----	-----	-----	-----	-----	-----	-----	-----	-----	-----	-----	-----	-----	-----	-----	-----	-----	-----	-----	-----	-----	-----	-----	-----	-----	-----	-----	-----	-----	-----	-----	-----	-----	-----	-----	-----	-----	-----	-----	-----	-----	-----	-----	-----	-----	-----	-----	-----	-----	-----	-----	-----	-----	-----	-----	-----	-----	-----	-----	-----	-----	-----	-----	-----	-----	-----	-----	-----	-----	-----	-----	-----	-----	-----

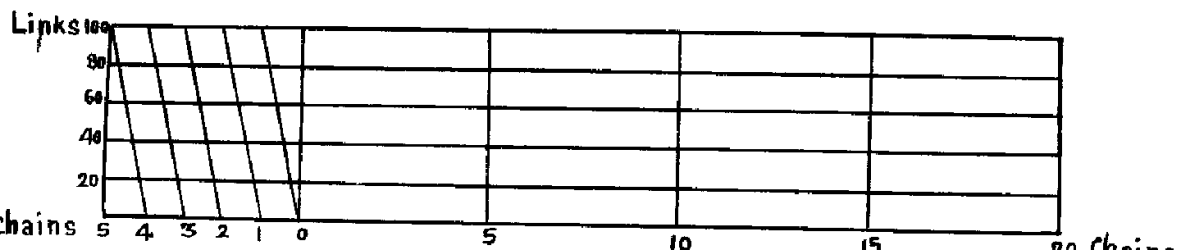

### NOTES

Plot in Possession

Certified that this map which has been finally prepared under sub-section (1) of section 22 of the Orissa Consolidation of Holdings and Prevention of Fragmentation of Land Act 1972 has been finally published in accordance with the provision contained in sub-section (2) of the side section read with rule 26 of the Orissa Consolidation of Holdings and Prevention of Fragmentation of Land Rules, 1973 on

*(Signature)*  
Asst. Consolidation Officer,  
Baliañta, Baliañta Circle.

**PROPOSED S+5 & B+S+5 RESIDENTIAL APPARTMENT BUILDING (MIG CATEGORY) OF SMT RAJSHREE PATNAIK, SMT. RITA PANIGRAHI, SRI SIVANANDA PRASAD NANDA REPRESENTED BY GPA HOLDER SRI RAJESH KIMAR NAYAK M.D OF M/s LAXMI INFRA VENTURE PVT. LTD. OVER PLOT NO-617,620,621,615 & 616 , KHATA NO-412/144,412/124,412/125 , MZ- RUDRAPUR , THANA-BALIANTA,TAHASIL-BHUBANESWAR,DIST-KHURDA.**





# M/s. Laxmi Infra Venture (P) Ltd.

Plot No : 315, Sahid Nagar, Bhubaneswar-751007

E-mail : laxmiinfra@gmail.com, Ph.: 0674-2549387, Cell : 9439201387, 9337265469

Ref No .....

Date .....

## Clarification on approach road to the project "LAXMI ANNEX"

That the proposed Residential Project (MIG) Category to be constructed under mouza-Rudrapur over (1) Khata No.412/144, Plot No.617, Area of Ac.0.380dec, (2) Khata No.412/124, Plot No.620 Area of Ac.0.180dec & 621 Area of Ac.0.080dec (3) Khata No.412/125, Plot No.615 area Ac.0.090dec & Plot No.616 area of Ac.0.090dec, Total One Mouza, Three Khata, Five Plots of Total area Ac.0.820dec, status-Stithiban, Kisham-Gharabari, Puri Canal Road, Hansapal, Bhubaneswar, Dist. Khurda,

That the Proposed Project 'Laxmi Annex' is just an adjacent to the puri main canal embankment road presently width 30' which connected to the NH-16 near at Hansapal. In the present status at site, our project plot No.621 is connected to the plot No.635 which is presently used as public road and covered under the CDP map.

Hence there is direct connection of road to our proposed project namely "Laxmi Annex".

M/s. Laxmi Infra Venture (P) Ltd.

  
Managing Director

LAXMI  
INFRA VENTURE PVT. LTD





M/s. Laxmi Infra Venture (P) Ltd.

*Rajesh Kumar Nayak*  
 Managing Director

**Naharkanta**

Sulgarh Square



**OFFICE OF THE SUPERINTENDING ENGINEER,  
PRACHI DIVISION, BHUBANESWAR-12**

E-mail : Prachi.division@yahoo.co.in, Phone: 06742562427

Letter No. 1327

Dated 13/5/22

To

M/s Laxmi Infra Venture (P) Ltd.,  
Plot No.315, Saheednagar,  
Bhubaneswar – 07.

**Sub : Grant of NOC to access the Plot No.621 through the plot No.635  
from Puri Main Canal embankment Road under Mouza-Rudrapur.**

Ref : Your application No.LIVPL/Annex/21-22/39 dtd.13.05.2022

Sir,

With reference to your application and view of Asst. Executive Engineer Baliyanta Division, the plot No.621 is access through plot no635 under Mouza-Rudrapur which is closed to the Puri main canal embankment road of plot No.250. As per CDP Map the canal embankment road is proposed to width of 80' and it covered the Plot No.250 & 635. Hence, this office has no objection to access the project plot from left embankment of puri main canal road with the following stipulations.

1. You will ensure construction of approach road over the Nayanjori plot shall not create drainage congestion in future. Cross Drainage work with adequate vent as decided by Department shall be constructed for safe passage of rain water.
2. This Dept. reserves the right to withdraw/modify the permission, if required in public interest.
3. You will take care of any law-and-order situation arising due to the work.
4. You will not claim for any compensation in case the permission is withdrawn or modified by Govt. if required at any point of time.
5. No personal construction activities/permanent structure shall be done over the Nayanjori plot by you. The proposed road will be used by the public for general purpose.

This is for your information and necessary action.

Yours faithfully,

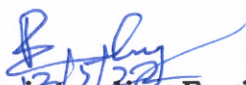
  
**Superintending Engineer  
Prachi Division, BBSR.**