

# SHEETAL REAL ESTATE PRIVATE LIMITED

BUILDERS & DEVELOPER'S

3/ANDAJ (M ARU)  
ANGUL - 759122 (ORISSA)

Date: 08.09.2014

To

The Manager  
Angul Electrical Division  
Angul.

Subj; No Objection certificate to my Shopping Complex -cum-Residential Flat at Gandhimarg Chowk, Angul (Plot No.578, 578/937, 577/2740, 540, 541.

Sir,

With due respect, I want to Construct a Shopping Complex-cum-Residential Flat at my above Plot No. as mentioned above ( Flat 52 Nos (2/3 bed room, Shopping complex 80-90 rooms) for the same, I want to install a 250 KVA S/S at own cost and arrangement.

So, I therefore request you please give me a NOC for the approval of TAMDA permission and obliged.

Thanking you.

Yours faithfully,  
Sheetal Real Estate (P) Ltd.

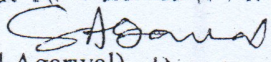
  
(Sunil Agarwal) Director  
Sheetal Real Estate Pvt. Ltd. 8/9/14

Encl:

1. TAMDA Notice
2. Sanction diagram of my plot

N  
S

VILL = HULURI SINGA,  
P.S = ANGIUL - NO. 63.  
DIST = ANGIUL,

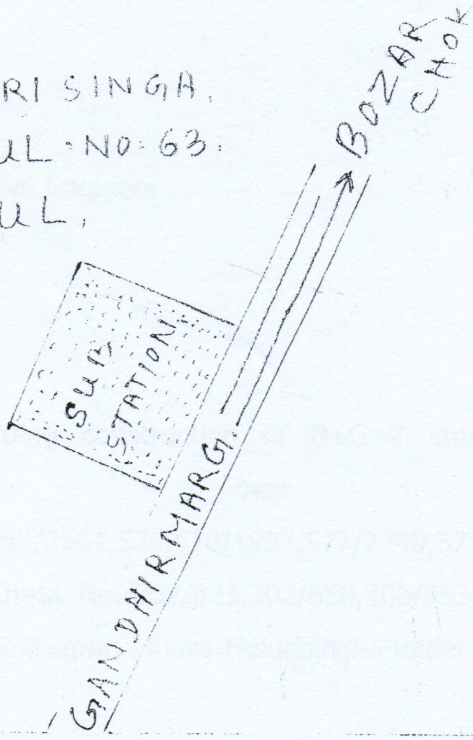

HAM SUR  
PADA.

HULURI SINGA.

Sheetal Real Estate (P) Ltd.

*Sheetal*  
Director

8914

TOTAL AREA.  
AC - 131

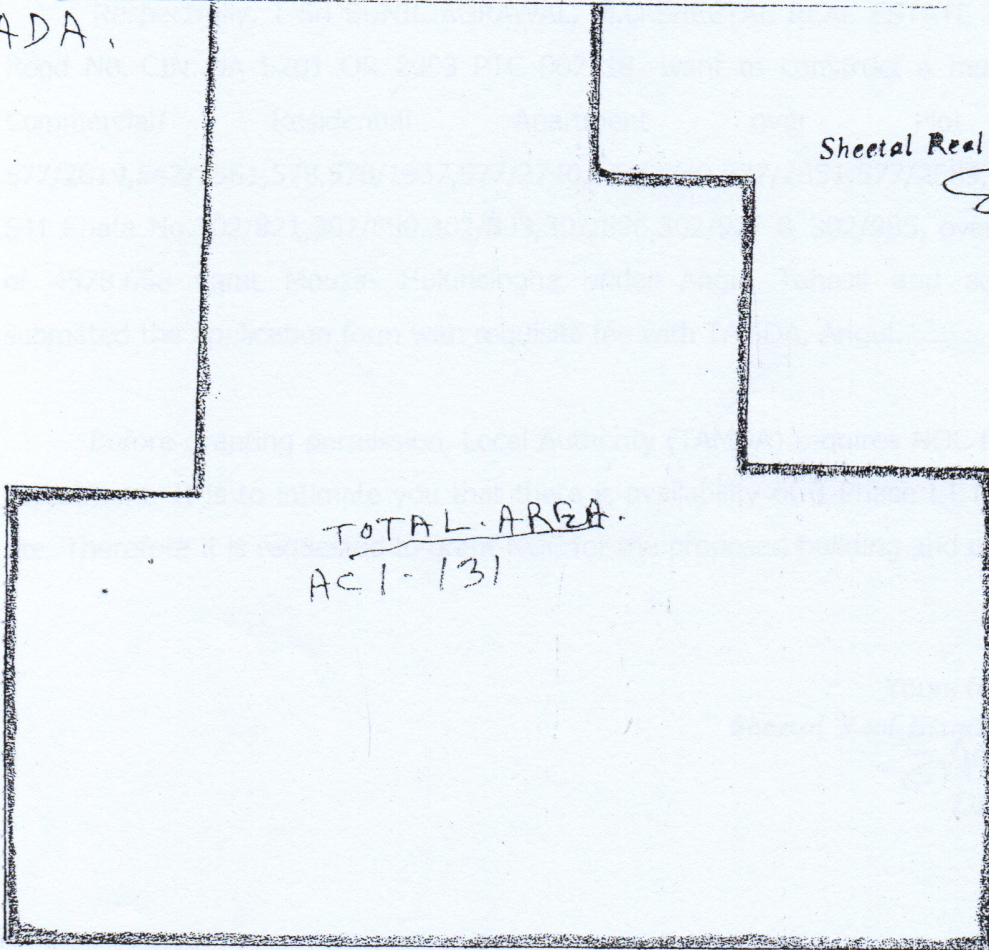

Date: 13/11/2014

To  
The Executive Engineer  
CESU, Angul

Sub- NOC regarding construction of B+G+7 storied Commercial/ Residential Apartment over Plot No 577/2819,542/2561,578,578/1937,577/2740,577/2740,577/2851,577/2689,540 & 541 Khata No.-302/821,302/850,302/893,302/896,302/977 & 302/985 Area 4578.658 sqmt, Mouza-Hulurisingha under Angul Tahasil.

Sir,

Respectfully, I Sri SUNIL AGRAWAL, M.D-SHEETAL REAL ESTATE PVT LTD, Regd No.-CIN..UA 5201 OR 2003 PTC 007318 -want to construct a multi-storied Commercial/ Residential Apartment over Plot No. 577/2819,542/2561,578,578/1937,577/2740,577/2740,577/2851,577/2689,540 & 541 Khata No.302/821,302/850,302/893,302/896,302/977 & 302/985, over an Area of 4578.658 sqmt Mouza- Hulurisingha under Angul Tahasil and accordingly submitted the application form with requisite fee with TAMDA, Angul.

Before granting permission, Local Authority (TAMDA) requires NOC from your department. It is to intimate you that there is availability of 3 Phase LT line at the site. Therefore it is requested to grant NOC for the proposed building and obliged.

Yours faithfully,  
Sheetal Real Estate (P) Ltd.

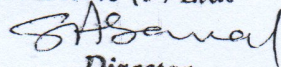
  
Director

24-

Cuttack

Sudaman Jena

9861661824

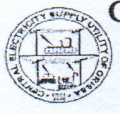

**CENTRAL ELECTRICITY SUPPLY UTILITY OF ODISHA**  
OFFICE OF THE MANAGER (ELECT)  
ANGUL ELECTRICAL DIVISION, ANGUL

Phone 06764-230450, Fax- 06764-231715, Email-eeaned@cescoorissa.com

No.....8046.....

Date.....12.09.14.....

To

**The Director,**  
Sheetal Real Estate Pvt Ltd  
At: Gamdhi Marg, Po/Dist. Angul

**Sub: Issue of assurance letter for power supply to your proposed 180 K.W load for Shoping Complex Cum Residential Flat At. Gandhi Marg, Angul**

Ref: Your application letter No. Nil Dt. 08.09.2014.

Sir,

With reference to the above, as per your request letter, CESU can supply the power from our existing supply system subject to the following terms and conditions.

**Terms & Conditions.**

1. You have to deposit the estimate cost for any addition or modification required of 11 KV line, L.T line & up-gradation of power transformer for giving power supply to your unit. (If required)
2. You have to install the required 11/0.4 KV 250 KVA S/S along with construction of 11 KV line at your own cost and arrangement.
3. This assurance letter is valid for a period of 6 (Six) months from the date of issue of this letter.

Yours faithfully,

↓  
**MANAGER (ELECT)**  
**A.E.D, ANGUL**  
*[Signature]*



**CENTRAL ELECTRICITY SUPPLY UTILITY OF ODISHA**

OFFICE OF THE MANAGER (ELECT)  
ANGUL ELECTRICAL DIVISION, ANGUL

Phone 06764-230450, Fax- 06764-231715, Email-eeaned@cescoorissa.com

No 10048

Date 18-11-2014

To

The Secretary,  
TAMDA, Angul. ✓

**Sub: NOC regarding power supply to B+G+7 Storied Commercial/Residential Apartment of Director, Sheeta Real Estate (P) Ltd At. Hulursingha, Angul over khata no. 302/985 plot no. 540, 541, 544, 512, 513 khata no. 302/977 plot no. 517/1788, 517/1782, 577/2689 khata no. 302/896 plot no. 577/2740, 577/2741, 577/2851 khata no. 302/893 plot no. 578, 578/1937, khata no. 302/850 plot no. 542/2561 khata no. 302/821 plot no. 577/2819 under No.1 Section, Angul.**

Sir,

With reference to the above, CESU can supply the power from our existing supply system subject to the following terms and conditions.

**Terms & Conditions.**

1. The power supply to proposed B+G+7 Storied Commercial Cum Residential Apartment can be provided after applying of required load in Form No.2 by the consumer.
2. The party has to deposit the estimate cost for any addition or modification required of 11 KV line, L.T line & up-gradation of power transformer (if required) for giving power supply to his Apartment.
3. The party has to install the required capacity of S/S along with construction of 11 KV line (if required) at his own cost and arrangement.

Yours faithfully,

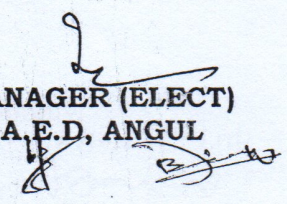
  
MANAGER (ELECT)  
A.E.D, ANGUL

Memo No 10049

Date 18-11-14

Copy to Director, Sheeta Real Estate (P) Ltd At. Hulursingha PO/Dist. Angul for information and necessary action.

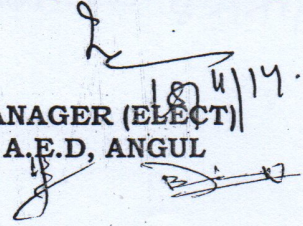
  
MANAGER (ELECT)  
A.E.D, ANGUL