

SL. NO.	LAND USE DESCRIPTION	COLOR CODE	AREA UNDER LAND USE (Sq.MT)	% OF LAND USE TO THE TOTAL PROJECT AREA	PRESCRIBED NORM OF PLANNING AUTHORITY
1	RESIDENTIAL USE	[Yellow]	390.73	62.28	
2	COMMERCIAL USE	[Blue]			
3	PLANTATION USE	[Green]	64.00	10.21	1 TREE PER 80 SQM
4	PARK/GARDEN USE	[Light Green]			
5	PLAY GROUND USE	[Light Green]			
4	COMMUNITY HALL	[Red]	15.89	2.53	
7	GYMNASIUM	[Brown]			
8	SWIMMING POOL	[Blue]			
9	INTERNAL ROAD	[Grey]	117.70	18.76	
10	ELECTRICAL SUBSTATION	[Orange]	9.00	1.43	
11	S. T. P.	[Purple]	12.00	1.91	
12	RECHARGE PIT	[Pink]	18.00	2.88	
TOTAL PLOT AREA : 627.32 SQM					



This is to certify that the body of the color layout plan has been prepared as per the Odisha Real Estate Regulatory Authority (ORERA). The same has been prepared strictly in accordance with the layout plan approved by the competent planning authority.

Er. Biraja Prasad Patra
 MEMBER
 CHARTERED ENGINEER
 M-118959/4
 FELLOW, INSTITUTION OF VALUERS (I)
 F-12312
 PANEL VALUER
 SCHEDULED BANKS

Isali Care Estates & Health Pvt. Ltd.
Sona Bari Pradhan
 Managing Director

TITLE
 PROPOSED RESIDENTIAL APARTMENT
 BUILDING PLAN OF MR. SANTOSH KUMAR TRIPATHY
 OVER PLOT NO - 1212/10701,1213 ,KHATA NO-495/5002,
 495/5126, AT MOUZA-LOCHAPADA ,
 TAHSIL- KUKUDAKHANDI, DIST- GANJAM

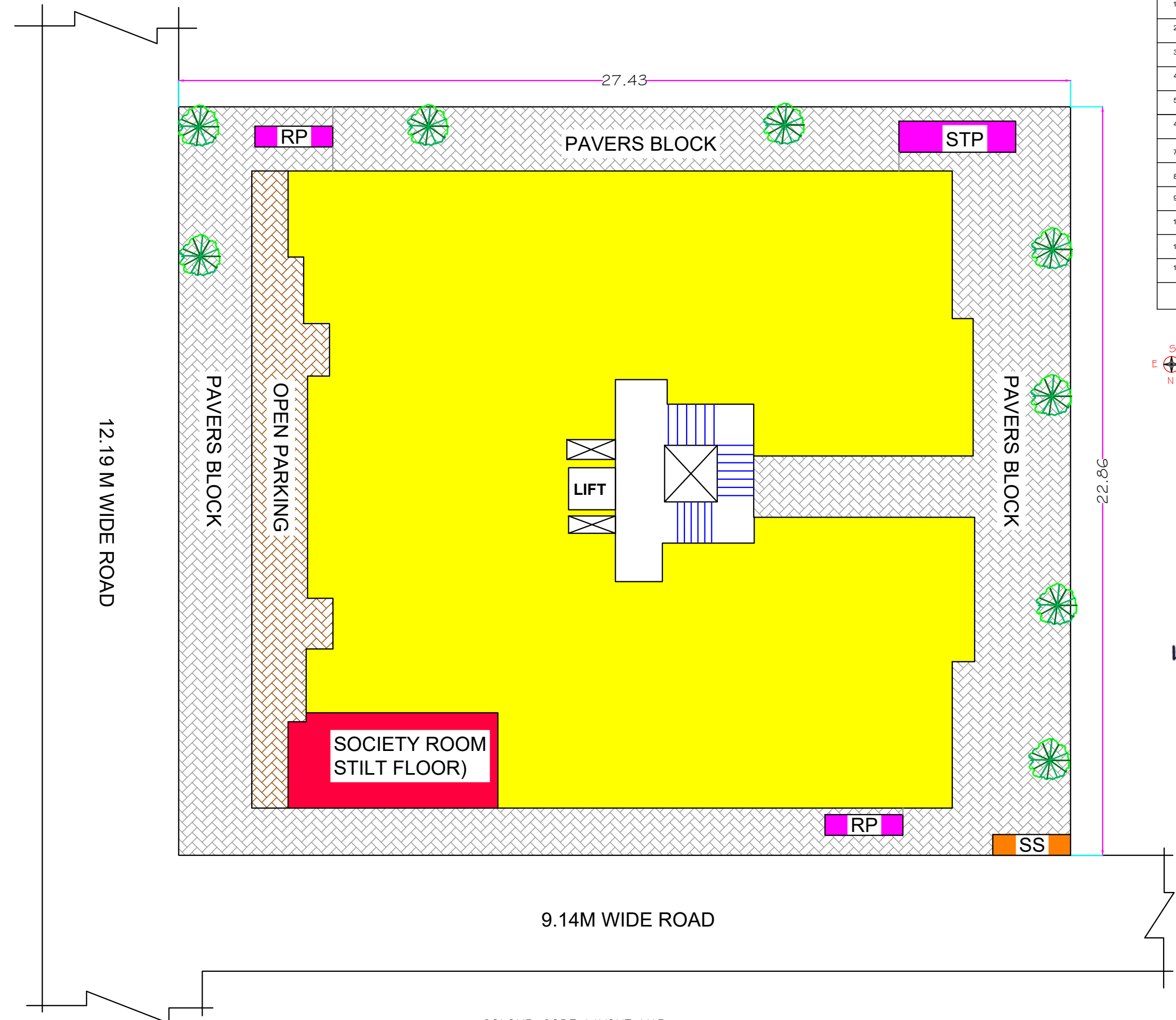

COLOUR CODE LAYOUT MAP