

**Proposed Residential Layout Plan (Sub Division of Plots)
over Revenue Plot Nos. 169/5807, 170/4372,
171/4373/5795, 173 & 177/5808 of Mouza : Pathara,
Tahasil : Kanisi, Dist. : Ganjam of Dr. Subhadra Rath.**

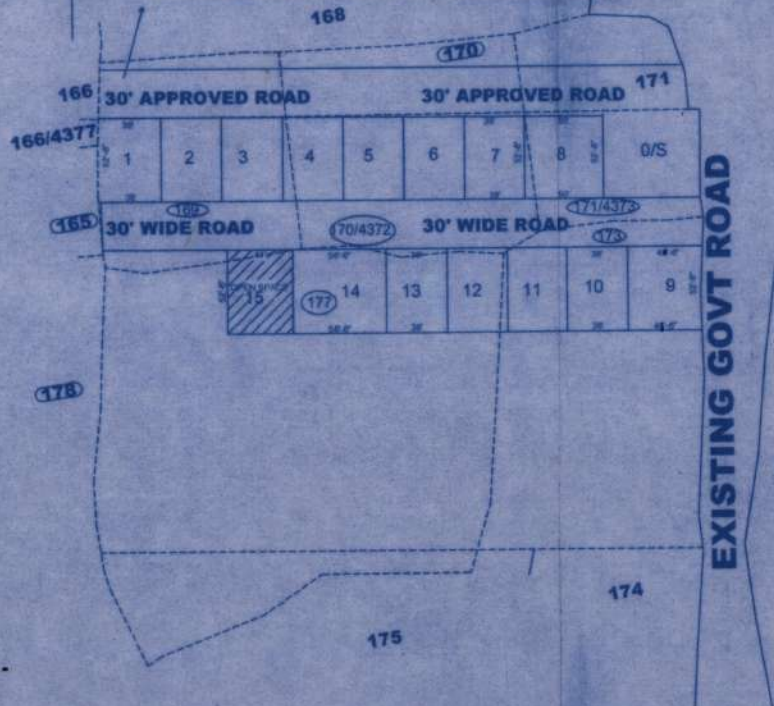

Layout Plan Approved By BDA Vide Letter No 2878/Dt 01/08/2001



LAND PARTICULARS			
KHATHA NO	SURVEY NO	TOTAL EXTENT	RESIDENTIAL LAND USE IN Ac.
849/1372	170/4372	0.343	0.343
849/1377	173	0.580	0.167
849/1374	171/4373/5795	0.155	0.088
849/1373	169/5807	0.225	0.214
849/1378	177/5808	0.900	0.172
		TOTAL	0.984

SL. NO.	NO. OF PLOTS	SIZE OF PLOT	AREA IN SFT.	AREA IN Ac.	USE
1 TO 7	7	38'0" X 52'6"	13965	0.321	RESIDENTIAL
8	1	50'0" X 52'6"	2625	0.060	-DO-
9	1	46'6" X 52'6"	2478	0.056	-DO-
10 TO 13	4	38'0" X 52'6"	7980	0.183	-DO-
14	1	58'6" X 52'6"	3071	0.071	COMMERCIAL
TOTAL RESIDENTIAL AREA			29819	0.695	
15	1	41'0" X 52'6"	2153	0.049	OPEN SPACE
16				0.250	ROAD
TOTAL LAYOUT AREA				0.984	

Subhadra Rath.

Signature of the Land Owner

Dr. Subhadra Rath

V. Tulasi Ram
Er. V. Tulasi Ram

Regd. Technical Person
as Civil Engineer Under

Signature of the technical person

Odisha Development Authorities
Directorate of Town Planning, Odisha -
Regd. No. RTP / DTP (C.ER)-169/2019
M 9702290272

SLGA-02/2021
Permission granted under sub section (3)
of Sec. 16 of the Orissa Development
Authorie Act 1982 (Odisha Act. 14 of
1982) subject to the conditions stated in
the letter No. 308 Dated 18-7-2022
for Residential Layout use
and valid till.....

[Signature]
Town & Regional Planning Member
Berhampur Development Authority

CHECKED

[Signature]
02.7.22
Planning Assistant
Berhampur Development
Authority, Berhampur (Gm.)