

PROPOSED RESIDENTIAL LAY OUT PLAN FOR GAYATRI VIHAR OVER SURVEY NOS. 285-289,
266-276, 1280-1288, 2479 OF MOUZA- AMBAPUA, S.NOS. 85-94, 96, 99-108, 110-113 & 1709 OF
MOUZA-PATHARA, IN BERHAMPUR TOWN.
SCALE - 64 INCHES TO ONE MILE.

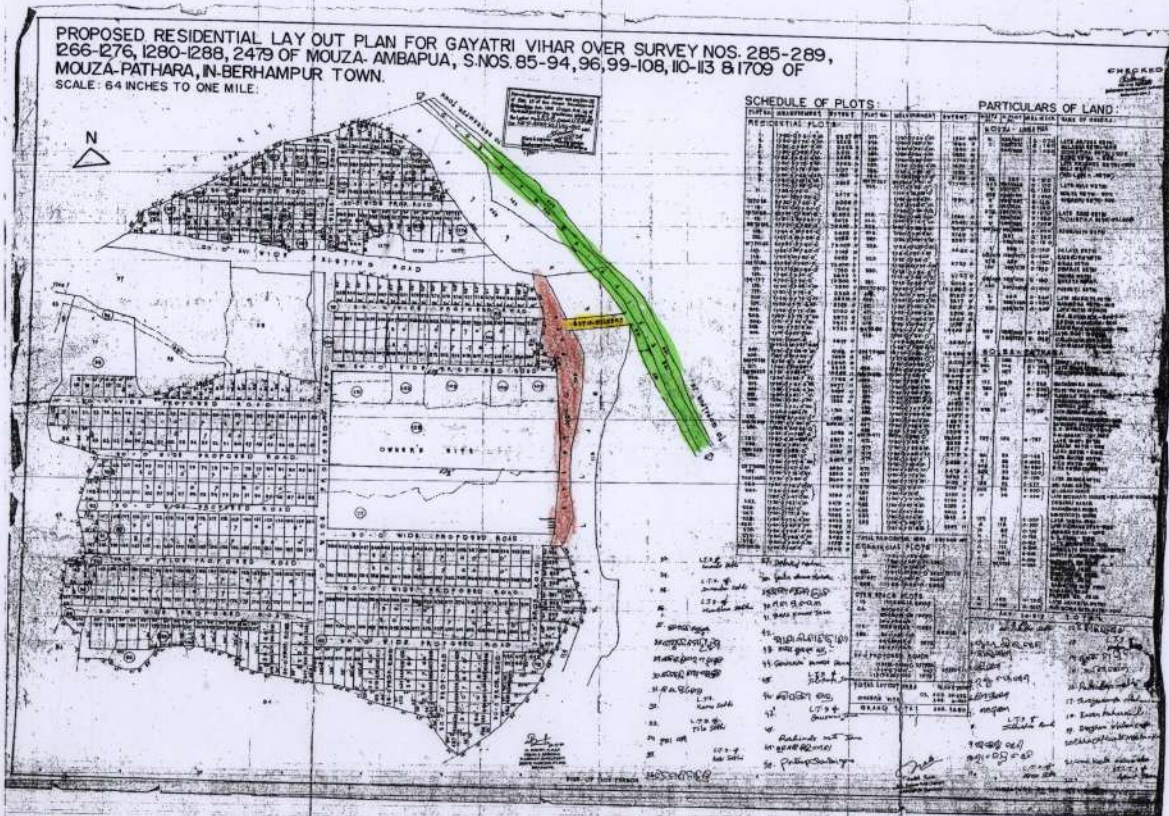

SCHEDULE OF PLOTS:

RESIDENTIAL PLOTS	AREA	REMARKS
1
2
3
4
5
6
7
8
9
10
11
12
13
14
15
16
17
18
19
20
21
22
23
24
25
26
27
28
29
30
31
32
33
34
35
36
37
38
39
40
41
42
43
44
45
46
47
48
49
50
51
52
53
54
55
56
57
58
59
60
61
62
63
64
65
66
67
68
69
70
71
72
73
74
75
76
77
78
79
80
81
82
83
84
85
86
87
88
89
90
91
92
93
94
95
96
97
98
99
100
101
102
103
104
105
106
107
108
109
110
111
112
113
114
115
116
117
118
119
120
121
122
123
124
125
126
127
128
129
130
131
132
133
134
135
136
137
138
139
140
141
142
143
144
145
146
147
148
149
150
151
152
153
154
155
156
157
158
159
160
161
162
163
164
165
166
167
168
169
170
171
172
173
174
175
176
177
178
179
180
181
182
183
184
185
186
187
188
189
190
191
192
193
194
195
196
197
198
199
200

- █ Existing Main Road
- █ Culvert.
- █ Existing 30' width Path way

Keeping in view of the existing Main Road and culvert made over the Nala which connect to the existing pathway, Brahmapur Development Authority approved the layout plan vide permission No. 3878/1-8-2001 which contains 276 Nos. Sub-Plots. This layout is part of the aforesaid layout.