



ALLTRADE
CONSTRUCTION

ALLTRADE CONSTRUCTION PVT. LTD.

CIN: U5201OR2010PTC012209

Idco Plot No- 71/b, Idco Industrial Estate
Mancheswar, Bhubaneswar-751017, Khurda (Odisha)

Web. : Info@alltradeconstructions.com

CLARIFICATION

The drawing plan for the proposed apartment building was prepared by the Architect on the basis of Sabik Revenue Map during the year 2018. As per the Sabik Revenue Map the demarcation line of the plot over which the apartment is proposed to be developed is shown in the site drawing plan which has been up loaded in the respective place. Since, the Hal Revenue Map has been published; the Cadastral Map is prepared as per the Hal Revenue Map. It is seen that, the demarcation line of the designated plot and also some of the neighbouring plots have been changed. As such a Cadastral Map for the proposed area has been prepared on the basis of the Hal Revenue Map with 19 Latitude & Longitude points and uploaded in the respective place for registration of the project " NIDO DE AAMOR". To clarify difficulties, both the revenue map (Sabik & Hal) are enclosed here with for better appraisal.

ALLTRADE CONSTRUCTION PRIVATE LIMITED

Joshna K. Patra

Managing Director

ALLTRADE CONSTRUCTION PRIVATE LIMITED

Nandini

Authorised Signature

HAL MAP

61101-0110021

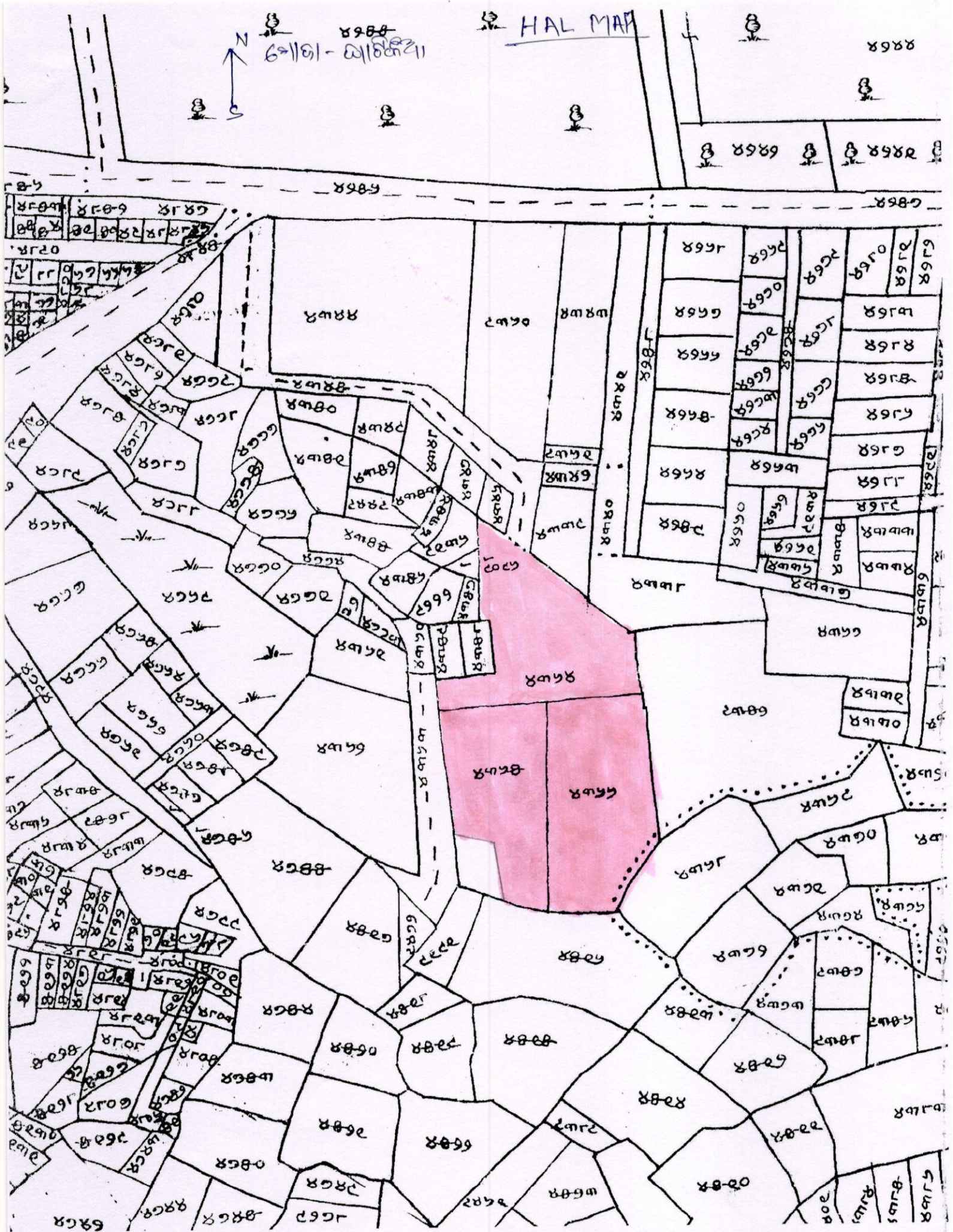
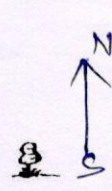

ALLTRADE CONSTRUCTION PRIVATE LIMITED

Abdul
Authorised Signature

CADASTRAL MAP

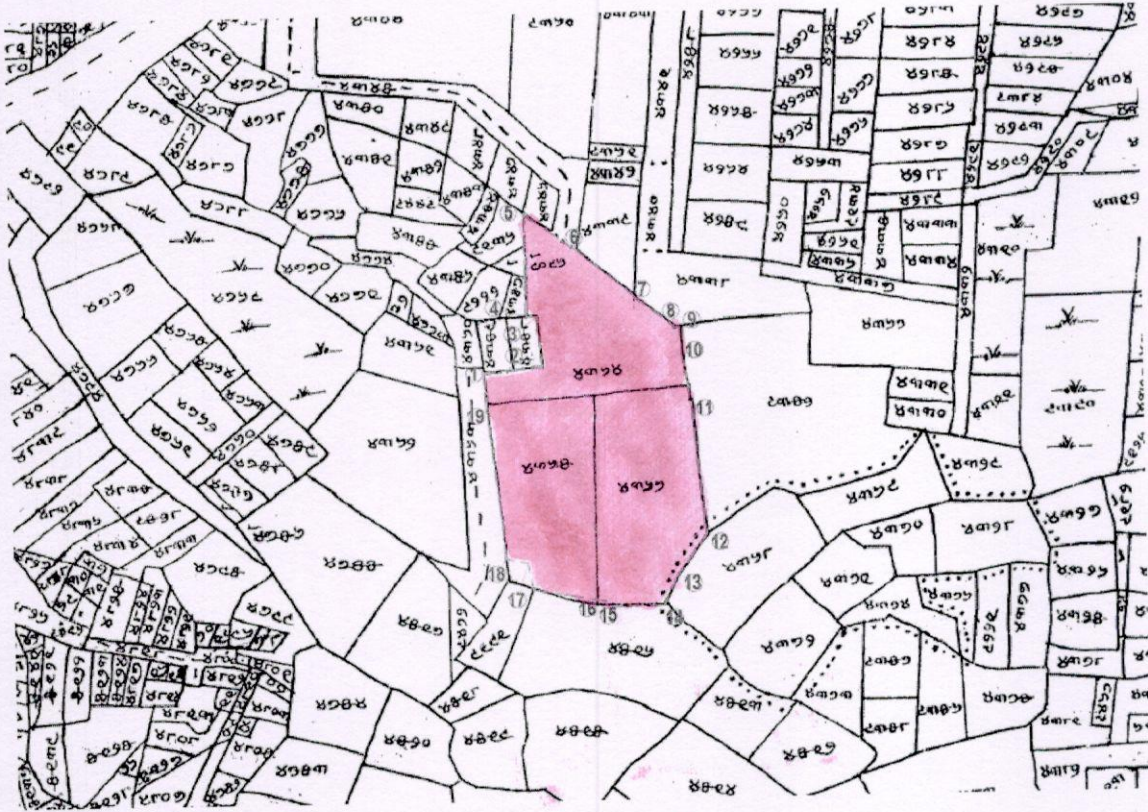

ALLTRADE CONSTRUCTION PRIVATE LIMITED

[Handwritten Signature]
Authorised Signature